

**COUNTY OF LOS ANGELES
ROAD DEPARTMENT**

**PRECISE
BENCH MARK LIST**



OTTERBEIN QUAD

1980 ADJUSTMENT

P R E F A C E
1980 Adjustment

The Road Department level net published in 1975 consisted of more than 1500 miles of levels supporting in excess of 18,000 bench marks. For reasons of economy, this 1980 adjustment is reduced to about 55% of the bench marks previously published. Reductions were made by increasing the spacing between level lines in unincorporated territory, and eliminating lines in non-contract cities and areas where the probability of future engineering projects appears slight. The 1980 adjustment is an update of the remainder of the 1975 bench marks, not including baselines. Data from previous adjustments is available without inferring any responsibility for the current reliability of the data or the actual existence of the bench marks. Elevations of bench marks with the same quad name, but different adjustment dates, are not normally compatible.

To facilitate the adjustment, indexing, and distribution of adjusted values of the net, the County territory is divided into 34 quads or areas. For identification purposes each quad is given a name, viz., "Rosemead," "La Mirada," "Santa Fe," etc. When bench marks and elevations in the Road Department net are used, the name of the quad in which the bench mark is located and the date of the elevation adjustment must be included in the bench mark description, e.g.,

CY 6901 - RDEM TAG S CB 11FT E BCR @ SE COR LA CIENEGA
BLVD & LENNOX BLVD 32FT S & 73FT E C/L INT
(HAWTHORNE - 1980) ELEV. 82.549

The precision of the net is reflected by an indicated field probable error of plus or minus 0.012 foot per mile of leveling as determined from over 300 conditions of closure. However, many years experience in vertical control in the greater Los Angeles basin and Antelope Valley indicate that because of varying degrees of subsidence and heaving, the true datum is recovered only by obtaining substantial agreement between a number of bench marks.

The users of this net are invited to assist in its maintenance by notifying this Department of cases of obliteration, apparent mistakes in descriptions or elevations, and proven disturbance of bench marks.

DATUM: U. S. Coast and Geodetic Survey Sea Level Datum
of 1929, through the medium of the Los Angeles
County Engineer Precise Level Net.

ABBREVIATIONS USED IN BENCH MARK LISTINGS

ABUT - - - - -	Abutment	EC - - - - -	End of Curve
ALG - - - - -	Along	ENT - - - - -	Entrance
ANG PT - - - - -	Angle Point	FL - - - - -	Floor
B/W - - - - -	Back of Walk	FTG - - - - -	Footing
BCR - - - - -	Beginning of Curb Return	FRWY - - - - -	Freeway
BC - - - - -	Beginning of Curve	F/W - - - - -	Front of Walk
BLDG - - - - -	Building	GAR - - - - -	Garage
BM - - - - -	Bench Mark	HDWL - - - - -	Headwall
BT SPK - - - - -	Boat or Bolt Spike	HSE - - - - -	House
BR CAP - - - - -	Brass or Bronze Cap	HWY - - - - -	Highway
C B - - - - -	Catch Basin	INT - - - - -	Intersection
CTR - - - - -	Center	IP - - - - -	Iron Pipe
C/L - - - - -	Center Line	LT - - - - -	Left
C/L INT - - - - -	Center Line Intersection	LACE - - - - -	L. A. City Engineer
C/L PROD - - - - -	Center Line Produced	LACS - - - - -	L. A. Co. Engineer
CONC - - - - -	Concrete	LAFC - - - - -	L. A. Co. Flood Control
COR - - - - -	Corner	L&BN - - - - -	Lead and Bench Nail
COE - - - - -	Corps of Engineers	L&BR - - - - -	Lead and Brad
CULV - - - - -	Culvert	L&N - - - - -	Lead and Nail
CYN - - - - -	Canyon	L&SPK - - - - -	Lead and Spike
CB - - - - -	Curb	L&T - - - - -	Lead and Tack
CS MON - - - - -	Co. Engineer Monument	MCR - - - - -	Middle of Curb Return
CT SPK - - - - -	Cut Spike	MKD - - - - -	Marked
DR - - - - -	Drive or Driveway	MC - - - - -	Middle of Curve
E/O - - - - -	East of	MON - - - - -	Monument
ECR - - - - -	End of Curb Return	N/O - - - - -	North of

ABBREVIATIONS USED IN BENCH MARK LISTINGS . . . CONTINUED

NR - - - - - Near
OPP - - - - - Opposite
PI - - - - - Point of Intersection
PK&W - - - - - FK Nail and Washer
P/L - - - - - Property Line
POST - - - - - Point on Semi-Tangent
PP - - - - - Power Pole
PVMT - - - - - Pavement
PROD - - - - - Produced
RD - - - - - Road
RDEM - - - - - Road Dept. Bench Mark
RDEM TAG - - - - - Road Dept. Bench Mark Tag
RR - - - - - Railroad
RT - - - - - Right
R/W - - - - - Right of Way
SDMH - - - - - Storm Drain Manhole
SMH - - - - - Sewer Manhole
SPK - - - - - Spike
ST&W - - - - - Spike Tin and Washer
S/O - - - - - South of
TP - - - - - Telephone Pole
USC&GS - - - - - U. S. Coast and Geodetic Survey
USGS - - - - - U. S. Geological Survey
WK - - - - - Walk
W/O - - - - - West of

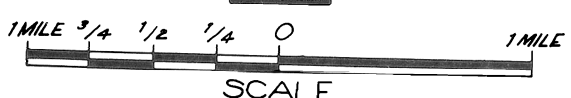
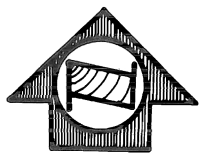
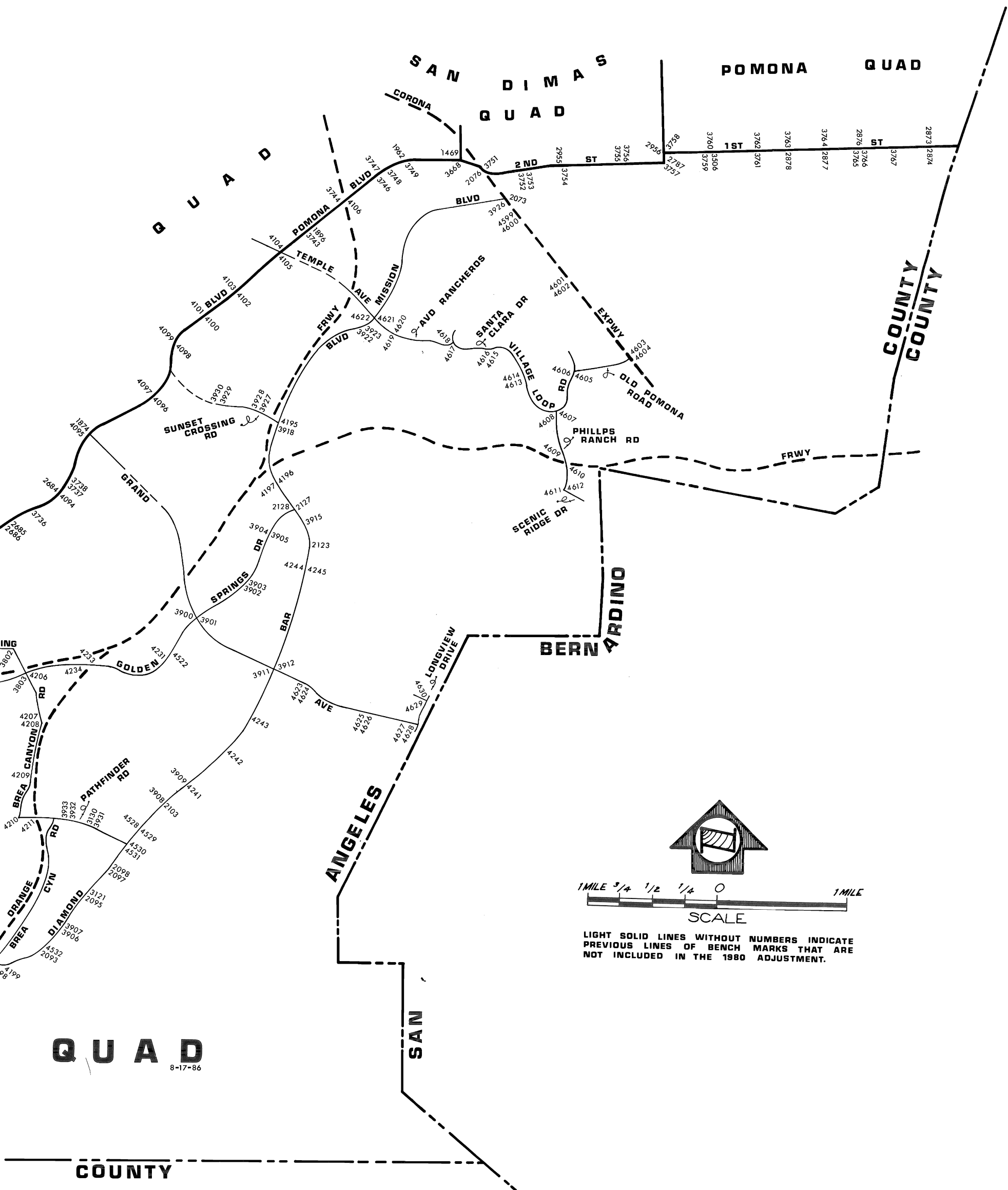

SCALE

LIGHT SOLID LINES WITHOUT NUMBERS INDICATE PREVIOUS LINES OF BENCH MARKS THAT ARE NOT INCLUDED IN THE 1980 ADJUSTMENT.

QUAD
8-17-86

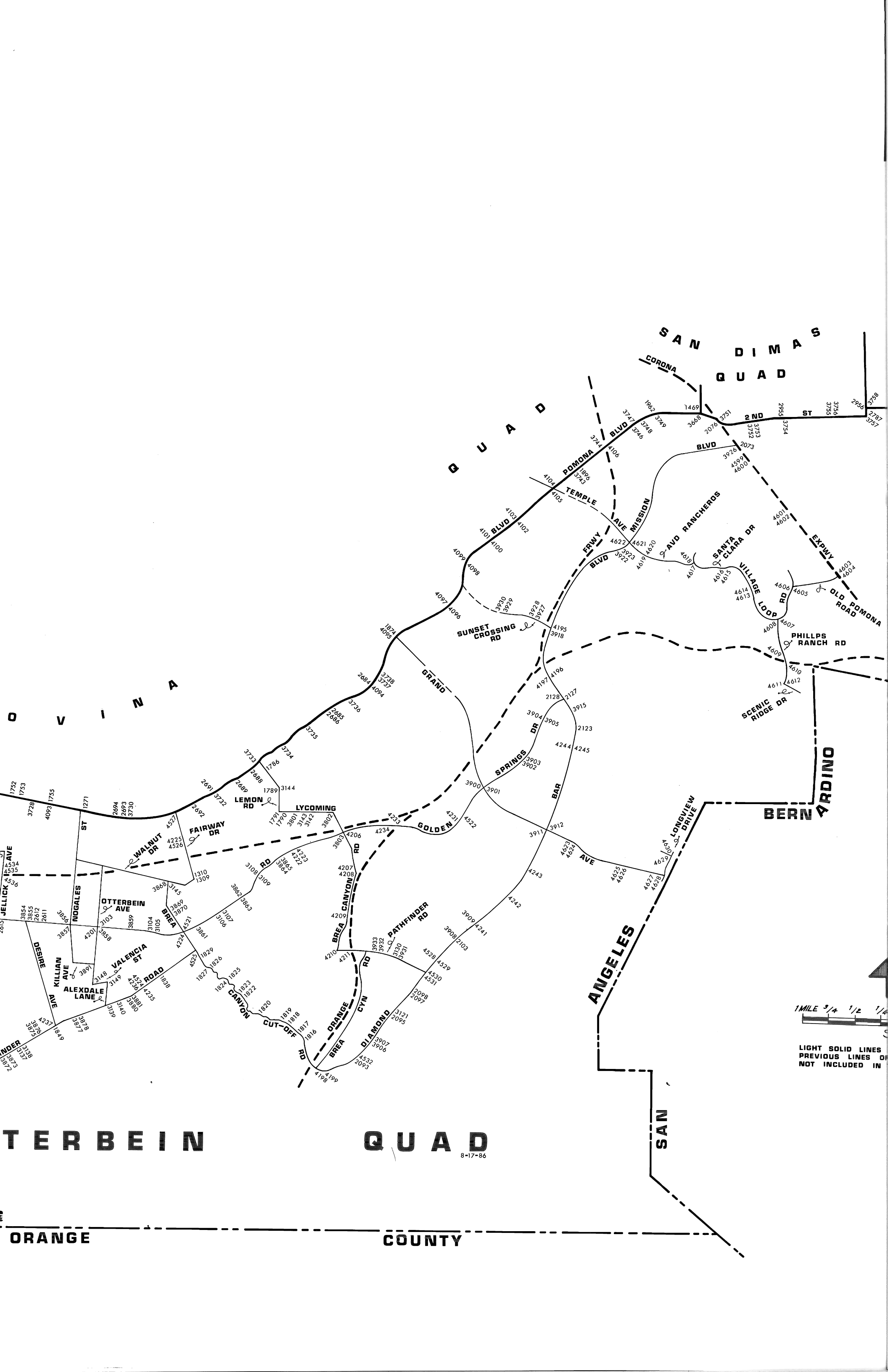

SAN DIMAS
QUAD

QUAD

OVINA

BERNARDINO

TERBEIN
QUAD

8-17-86

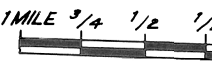

LIGHT SOLID LINES
PREVIOUS LINES OF
NOT INCLUDED IN

ORANGE COUNTY

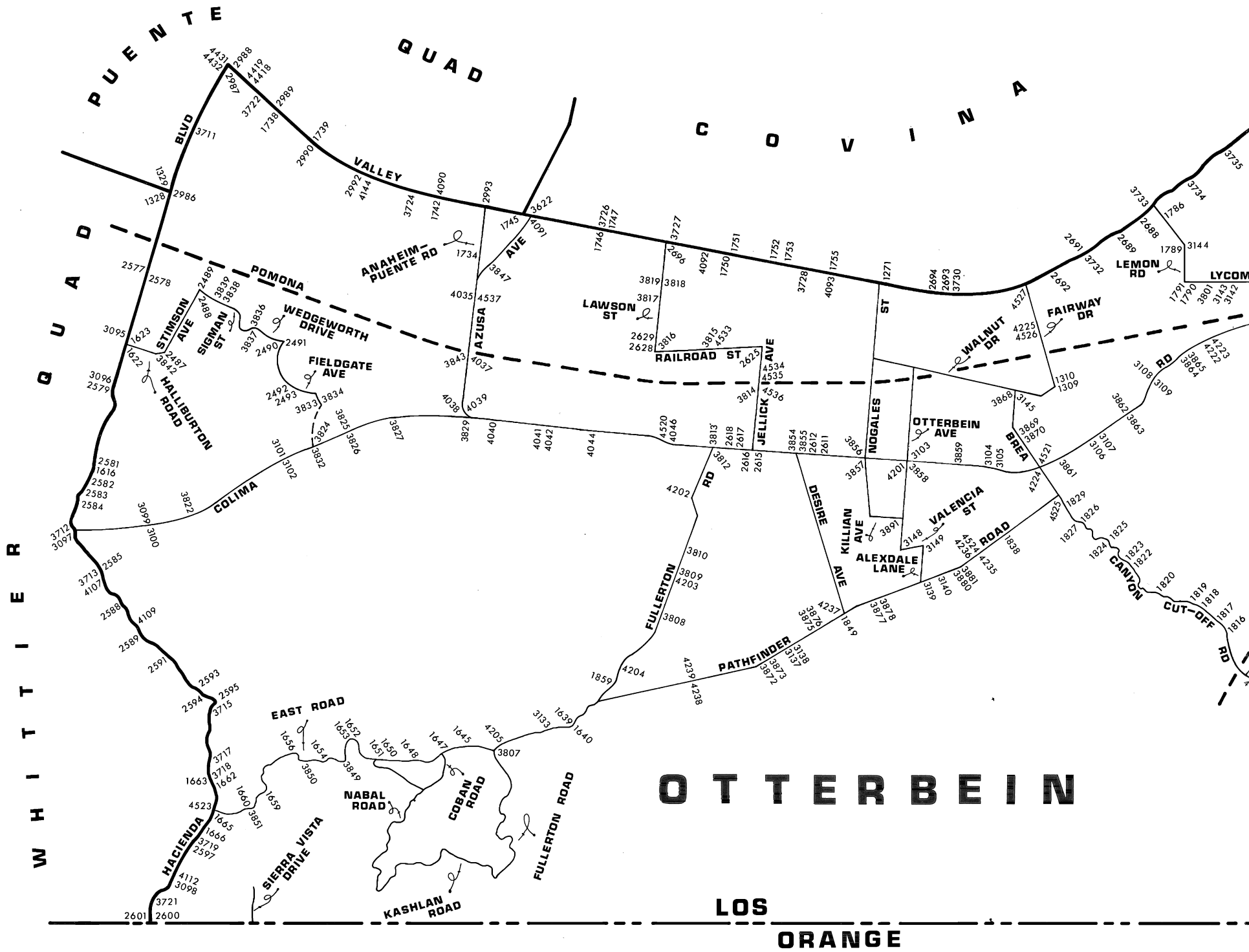

AD-YEAR	ELEV	DESCRIPTION (INCLUDE QUAD AND YEAR IN DESCRIPTION)	BM NUMBER
BASELINE (1975)	456.456	R D MON IN WELL 10 IN DN @ C/L INT VALLEY BLVD & NOGALES ST	CG 1271
OTTRBEIN (1980)	508.723	L&N W END CONC HDWL 18FT S C/L WALNUT DR & 20FT E C/L PROD FAIRWAY DR	CG 1309
OTTRBEIN (1980)	492.917	L&BN W END CONC HDWL OF DRAIN 15FT E C/L FAIRWAY DR & 450FT N C/L WALNUT DR	CG 1310
BASELINE (1975)	332.714	L&T NR CTR CB RET @ SW COR GALE AVE & HACIENDA BLVD 47FT S & 47FT W C/L INT MKD (BM P)	CG 1328
BASELINE (1975)	332.105	RDBM TAG N CB 9FT E BCR @ NW COR HACIENDA BLVD & GALE AVE 36FT N & 70FT W C/L INT	CG 1329
BASELINE (1975)	785.396	MWD BR MON FL IN HDWL 8FT N/O N RAIL SPRR 75FT S C/L MT VERNON AVE & 250FT W C/L BELLEVUE AVE MKD (62D 1933)	CG 1469
BASELINE (1975)	497.868	CS BRASS MON FL IN S WALL OF C B ON SE COR HACIENDA BLVD & LOS ALTOS DR 53FT S & 80FT E C/L INT MKD (BM 38-9A 1963)	CG 1616
BASELINE (1975)	406.170	RDBM TAG S CB & 1FT W BCR @ SE COR HACIENDA BLVD & HALLIBURTON RD & 40FT S C/L & 84FT E C/L INT	CG 1622
BASELINE (1975)	405.289	RDBM TAG N CB 1FT E BCR @ NE COR HACIENDA BLVD & HALLIBURTON RD 40FT N & 72FT E C/L INT	CG 1623
OTTRBEIN (1980)	658.961	RD MON IN WELL 8IN DN ON PI OF CURVE TO SW 12FT W/O C/L PVMT FULLERTON RD 30FT NW PP #875077E 2.0MI S/O COLIMA RD MKD (1950)	CG 1639
OTTRBEIN (1980)	653.444	RD BM TAG IN S END CONC HDWL 30FT SE/O C/L FULLERTON RD 18FT S/O PP NO 875077E & 2.0 MI S COLIMA RD	CG 1640
OTTRBEIN (1980)	829.913	L&T CONC DR TO HSE NO 1505 EAST RD 27FT N C/L & 0.2 MI W FULLERTON RD @ SE COR GARAGE	CG 1645
OTTRBEIN (1980)	779.076	L&T CONC FOUNDATION OF W BRICK GATE POST @ HSE NO 1409 EAST RD 20FT N C/L 70FT E C/L COBAN RD & 0.4 MI W FULLERTON RD	CG 1647
OTTRBEIN (1980)	746.803	RDBM TAG N WINGWALL CONC HDWL 13FT E OF ENT TO HSE NO 1276 EAST RD 15FT S C/L & 0.6 MI W FULLERTON RD	CG 1648
OTTRBEIN (1980)	720.227	RDBM TAG CTR CONC HDWL @ NE COR EAST RD & VALLE DR 21FT N & 12FT E C/L INT	CG 1650

IAD-YEAR	ELEV	DESCRIPTION (INCLUDE QUAD AND YEAR IN DESCRIPTION)	BM NUMBER
OTTRBEIN (1980)	720.085	L&T CONC DR TO HSE NO 1141 EAST RD @ NW COR VALLE DR 75FT N & 15FT W/O C/L INT	CG 1651
OTTRBEIN (1980)	731.893	L&T S CB DF DR TO HSE NO 1001 PAPAYA DR 20FT E C/L & 27FT N C/L PROD EAST RD	CG 1652
OTTRBEIN (1980)	716.815	RDBM TAG CTR CONC HDWL OF DROP INLET 21FT N C/L EAST RD & 300FT W C/L PAPAYA DR	CG 1653
OTTRBEIN (1980)	708.150	RDBM TAG IN CTR CONC HDWL 15FT N C/L EAST RD E PP NO 1124854E & 240FT S/O DEEP CYN RD	CG 1654
OTTRBEIN (1980)	727.982	CHIS X IN W POST STEEL GUARD RAIL 17FT S C/L EAST RD 100FT E/O DR TO HSE NO 640 & 0.2 MI WLY OF ELY CHURCH-HILL RD	CG 1656
OTTRBEIN (1980)	649.951	CHIS X S POST OF STEEL GUARD RAIL 15FT W C/L EAST RD & 0.2MI W/O WLY INT CHURCH-HILL RD 84FT N/O HSE NO 378	CG 1659
OTTRBEIN (1980)	605.907	L&T NW CB EAST RD 15FT NW C/L 45FT N TP NO W1678Y & 230FT S DRWY TO HSE NO365 0.25MI W LY OF WLY CHURCH-HILL RD	CG 1660
BASELINE (1975)	605.007	CSBM MON IN WELL BIN DN ON C/L ENCANADA DR 48FT W C/L INT HACIENDA BLVD MKD (BM 38-4 1954)	CG 1662
BASELINE (1975)	605.148	CS MON FLUSH @ SW COR HACIENDA BLVD & ENCANADA DR 23FT W & 20FT S C/L INT	CG 1663
BASELINE (1975)	555.034	L&T IN W END CONC STEP TO OFFICE @ SE COR HACIENDA BLVD & EAST RD 50FT E & 40FT S C/L INT MKD (BM)	CG 1665
BASELINE (1975)	512.596	L&BRAD 2FT S OF N END CONC HDWL OPP HSE NO 1703 HACIENDA BLVD 21FT E C/L & 0.15MI S EAST RD MKD (BM)	CG 1666
OTTRBEIN (1980)	376.494	L&T CONC RIM WATER VALVE BOX 45FT W C/L ANAHEIM-PUENTE RD & 550FT N/O RAILROAD ST 200FT S/O OFFICE OF DAY & NIGHT MFG CO (S EDGE DR OF GATE NO 1 - MKD BM)	CG 1734
BASELINE (1975)	335.777	L&T CONC FOUNDATION OF GAS STA 33FT W C/L ALBERT ST & 50FT S C/L OLD VALLEY BLVD MKD (BM)	CG 1738
BASELINE (1975)	343.573	RDBM TAG N CB 4FT E BCR 20FT N C/L OLD VALLEY BLVD & 420FT E C/L VALLEY BLVD OVER PASS	CG 1739
BASELINE (1975)	370.457	L&BN N CONC HDWL 75FT S C/L VALLEY BLVD & 150FT W C/L WICKFORD AVE	CG 1742

JAD-YEAR	ELEV	DESCRIPTION (INCLUDE QUAD AND YEAR IN DESCRIPTION)	BM NUMBER
BASELINE (1975)	379.468	RD MON IN WELL 7IN DN @ C/L INT VALLEY BLVD & AZUSA WAY	CG 1745
BASELINE (1975)	390.220	RD MON IN WELL 8IN DN ON C/L INT VALLEY BLVD & HAMBLEDON AVE	CG 1746
BASELINE (1975)	390.967	L&T N CB VALLEY BLVD 3FT E BCR @ NE COR HAMBLEDON AVE 36FT N & 47FT E C/L INT	CG 1747
BASELINE (1975)	412.514	L&BN IN RR SIGNAL BASE 75FT S C/L VALLEY BLVD & 35FT W C/L YORBITA RD	CG 1750
BASELINE (1975)	410.180	RDBM TAG CTR CONC HDWL 43FT N C/L VALLEY BLVD & 25FT E C/L YORBITA RD	CG 1751
BASELINE (1975)	420.027	RDBM TAG W CB 11FT N BCR 81FT N C/L VALLEY BLVD & 20FT W C/L LA SEDA RD	CG 1752
BASELINE (1975)	420.107	L&T E CB 12FT N BCR 82FT N C/L VALLEY BLVD & 20FT E C/L LA SEDA RD	CG 1753
BASELINE (1975)	433.053	RDBM TAG N CB 1FT W CATCH BASIN 40FT N VALLEY BLVD & 0.2 MI E LA SEDA RD	CG 1755
OTTRBEIN (1980)	520.929	RDBM TAG IN E CB LEMON AVE 30FT E C/L & 0.2 MI N CURRIER RD NR DRAINAGE BOX FROM DEL PASO HIGH SCHOOL	CG 1786
OTTRBEIN (1980)	527.490	RDBM TAG W END CONC HDWL 17FT S C/L CURRIER RD & 46FT E/O C/L LEMON AVE	CG 1789
OTTRBEIN (1980)	529.171	L&T NR CTR OF CURVED CONC HDWL 24FT N C/L LYCOMING ST & 26FT E C/L LEMON RD	CG 1790
OTTRBEIN (1980)	529.003	L&T NR CTR OF CURVED CONC HDWL 28FT S C/L LYCOMING ST & 26FT E C/L LEMON RD	CG 1791
OTTRBEIN (1980)	762.619	RDBM TAG NR CTR CONC HDWL 18FT N C/L BREA CANYON CUT OFF RD & 0.4MI N /O BREA CYN RD 25FT E/O PP #1452460E	CG 1816
OTTRBEIN (1980)	766.097	CS BR MON 2IN UP NR 2IN WHITE WITNESS PIPE 110FT N C/L BREA CANYON CUTOFF RD & 0.4MI N BREA CYN RD MKD (BM 12E 50FT W/O PP # 1452460E	CG 1817
OTTRBEIN (1980)	809.383	CS BR MON 2IN UP NR 2IN WHITE WITNESS PIPE 50FT E OF E END OF BRIDGE NO B 761 75FT N C/L BREA CANYON CUTOFF RD & 0.6MI N BREA CANYON RD MKD (BM 11)	CG 1818
OTTRBEIN (1980)	821.715	RDBM TAG NR CTR CONC HDWL 15FT N C/L BREA CANYON CUTOFF RD & 0.7MI N BREA CANYON RD	CG 1819

IAD-YEAR	ELEV	DESCRIPTION (INCLUDE QUAD AND YEAR IN DESCRIPTION)	BM NUMBER
OTTRBEIN (1980)	872.370	BT SPK IN CONC HDWL 15FT N C/L BREA CANYON CUTOFF RD & 0.85MI N BREA CANYON RD 550FT FROM SUMMIT MKD (BM 9)	CG 1820
OTTRBEIN (1980)	894.647	BT HD SPK IN CONC HDWL 21FT W C/L BREA CANYON CUT-OFF RD 0.2MI S/O OAKLEAF CYN RD 30FT S/O DRWY TO HSE NO 2545 (MKD BM NO 7)	CG 1822
OTTRBEIN (1980)	872.245	S & L IN E CONC HDWL 15FT W/O C/L BREA CYN CUT- OFF RD 0.15MI S/O OAK LEAF CYN RD (MKD BM NO 6)	CG 1823
OTTRBEIN (1980)	772.507	BT SPK IN CONC HDWL OF CATTLE UNDERPASS 16FT SW C/L BREA CANYON CUTOFF RD & 0.75 MI S COLIMA RD MKD (BM 3)	CG 1824
OTTRBEIN (1980)	770.275	RDBM TAG IN CONC HDWL TO CATTLE UNDERPASS 10FT NE C/L BREA CANYON CUTOFF RD & 0.75 MI S COLIMA RD	CG 1825
OTTRBEIN (1980)	725.242	L&BN IN CONC HDWL OF PAVED RD TO WATER TANK 10FT N C/L 66FT W C/L BREA CANYON CUTOFF RD & 0.6 MI S COLIMA RD MKD (BM)	CG 1826
OTTRBEIN (1980)	716.087	RDBM TAG CONC HDWL S/O MAC RD TO WATER TANK 36FT S C/L 25FT W C/L BREA CANYON CUTOFF RD & 0.6 MI S COLIMA RD MKD (BM)	CG 1827
OTTRBEIN (1980)	652.185	CS MON IN WELL 8IN DN @ C/L INT PATHFINDER RD & BREA CYN CUT-OFF RD 0.35MI S/O COLIMA RD & 171FT S/O ESQUILINE AVE MKD (PI NO 6 RE 5869) USE NO EDGE	CG 1829
OTTRBEIN (1980)	632.230	L & T IN BOTTOM STEP OF WK TO HSE NO 1843 BREA CYN RD 75FT S C/L STA 412&55 PATHFINDER RD (PROP) 0.4MI W/O BREA CYN CUT OFF RD MKD (BM)	CG 1838
OTTRBEIN (1980)	574.041	3/4IN IP & RE 248 TAG 8IN UP ALONG FENCE LINE 128FT W/O C/L DESIRE AVE & 50FT NLY OF C/L PATHFINDER RD PROD FROM E 0.95MI S/O COLIMA RD 75FT E/O PP	CG 1849
OTTRBEIN (1980)	629.114	L&BRAD E END OF HDWL 30FT W OF PI FULLERTON RD & 80FT E PP NO 1073667E 1.75MI S COLIMA RD @ WATER DISTRICT OFFICE	CG 1859
BASELINE (1975)	609.654	RD MON IN WELL 6IN DN @ PI GRAND AVE & 250FT N C/L VALLEY BLVD	CG 1874
BASELINE (1975)	705.767	CSBM MON IN WELL 10IN DN 21FT N C/L POMONA BLVD & 0.1MI E C/L TEMPLE AVE 1FT N/O N EDGE CONC PVMT MKD (BM 11-90-1952)	CG 1896

JAD-YEAR	ELEV	DESCRIPTION (INCLUDE QUAD AND YEAR IN DESCRIPTION)	BM NUMBER
BASELINE (1975)	771.148	RD BR CAP MON IN HDWL 80FT N'LY C/L POMONA BLVD 8FT S/O S RAIL SPRR 13FT E'LY C/L RIDGEWAY ST PROD 90FT S C/L MT VERNON AVE	CG 1962
OTTRBEIN (1980)	794.365	RDBM TAG 1FT N OF S END CONC HDWL @ NW COR 162FT W & 71FT N C/L INT CORONA EXPRESSWAY & MISSION BLVD	CG 2073
BASELINE (1975)	798.352	LACS MON IN WELL 13IN DN ON C/L 2ND ST IN MED ISL 2.5FT W/O END 310FT E C/L INT 2ND ST & HWY NO 71 (MKD BM 11-85)	CG 2076
OTTRBEIN (1980)	732.907	RDBM TAG IN CONC BOX CULV IN ISLAND 2FT E C/L DIAMOND BAR BLVD 0.1MI N C/L INT CROOKED CRK DR	CG 2093
OTTRBEIN (1980)	732.207	RDBM TAG 2FT S/O N END CONC HDWL 65FT E'LY & 12FT N'LY C/L INT DIAMOND BAR BLVD & FOUNTAIN SPRINGS RD	CG 2095
OTTRBEIN (1980)	756.625	RDBM TAG IN E SIDE CONC BOX CULV 2FT E C/L DIAMOND BAR BLVD & 0.15MI N SHADOW CYN DR	CG 2097
TTRBEIN (1980)	753.895	RDBM TAG NR N END CONC HDWL 65FT E'LY C/L DIAMOND BAR BLVD & 0.15MI N'LY SHADOW CYN DR	CG 2098
OTTRBEIN (1980)	809.949	RDBM TAG NR CTR CONC HDWL 135FT S'LY & 65FT E'LY C/L INT DIAMOND BAR BLVD & KIOWA CREST DR	CG 2103
OTTRBEIN (1980)	841.744	RDBM TAG IN CTR CONC HDWL 77FT E C/L DIAMOND BAR BLVD & 233FT S'LY GOLDRUSH DR	CG 2123
OTTRBEIN (1980)	768.344	RDBM TAG W CB 2FT S BCR @ SW COR DIAMOND BAR BLVD & GOLDEN SPRING DR 69FT S & 40FT W C/L INT	CG 2127
OTTRBEIN (1980)	762.868	RDBM TAG W CB 2FT N BCR @ NW COR DIAMOND BAR BLVD & GOLDEN SPRING DR 40FT W & 69FT N C/L INT	CG 2128
OTTRBEIN (1980)	420.890	CS TAG W CB 1FT N BCR @ NW COR HALLIBURTON RD & STIMSON AVE 87FT N & 30FT W C/L INT	CG 2487
OTTRBEIN (1980)	371.096	RAM SET S CB 1FT E BCR @ SE COR STIMSON AVE & SIGMAN ST 18FT S & 70FT E C/L INT MKD (SD 1223)	CG 2488
OTTRBEIN (1980)	370.518	RAM SET N CB 1FT E BCR @ NE COR STIMSON AVE & SIGMAN ST 18FT N & 69FT E C/L INT	CG 2489
OTTRBEIN (1980)	428.950	R E TAG NO 10103 1FT N BCR @ SW COR WEDGEWORTH DR & FIELDGATE AVE 45FT S & 18FT W/O C/L INT	CG 2490
OTTRBEIN (1980)	426.434	RE TAG NO 10103 E/O CB @ BCR & NE COR WEDGEWORTH DR & FIELDGATE AVE 45FT N & 20FT E/O C/L INT	CG 2491

IAD-YEAR	ELEV	D E S C R I P T I O N (INCLUDE QUAD AND YEAR IN DESCRIPTION)	BM NUMBER
OTTRBEIN (1980)	473.039	RDBM TAG NW CONC FTG OF EDISON TOWER NO 1-1 SECOND TOWER S WEDGEWORTH DR 200FT E FIELDGATE AVE	CG 2492
OTTRBEIN (1980)	473.074	RDBM TAG SW CONC FTG OF EDISON TOWER NO 1-1 SECOND TOWER S WEDGEWORTH DR 200FT E FIELDGATE AVE	CG 2493
BASELINE (1975)	360.980	L&T W CB HACIENDA BLVD 42FT W C/L @ C/L PROD SIGMAN ST	CG 2577
BASELINE (1975)	361.460	RDBM TAG S CB 17FT E/O BCR @ SE COR HACIENDA BLVD & SIGMAN ST 18FT S & 97FT E C/L INT CB	CG 2578
BASELINE (1975)	438.768	RD MON IN WELL 8IN DN @ C/L INT HACIENDA BLVD & TETLEY ST MKD (RD DEPT 1962)	CG 2579
BASELINE (1975)	497.194	L&T N CB 3FT E BCR @ NE COR HACIENDA BLVD & LOS ALTOS DR 17FT N & 80FT E C/L INT	CG 2581
BASELINE (1975)	498.800	L&T E CB (W CB SERVICE ISLAND) HACIENDA BLVD 30FT S BCR @ SE COR LOS ALTOS DR 60FT S & 42 FT E C/L INT	CG 2582
BASELINE (1975)	519.785	L&BN E CB (W CB SERVICE ISLAND) HACIENDA BLVD 2FT N BCR @ NE COR DEL PRADO DR 30FT N & 45FT E C/L INT	CG 2583
BASELINE (1975)	521.870	L&BN E CB (W CB SERVICE ISLAND) HACIENDA BLVD 2FT S BCR @ SE COR DEL PRADO DR 35FT S & 45FT E C/L INT	CG 2584
BASELINE (1975)	602.823	RDBM TAG NLY CB 32FT ELY BCR 72FT ELY & 20FT NLY C/L INT HACIENDA BLVD & RICHVIEW DR	CG 2585
BASELINE (1975)	709.322	CSBM MON FL 22FT WLY C/L HACIENDA BLVD & 0.3MI SLY C/L RICHVIEW DR 6FT OFF EDGE OF PVMT 2FT NLY CONC HDWL MKD (BM 38-7 1954)	CG 2588
BASELINE (1975)	844.540	L&T IN CONC WALL OF DRAIN 15FT W APPROX C/L HACIENDA BLVD 0.7MI SLY INT HACIENDA BLVD & RICHVIEW DR MKD (BM)	CG 2589
BASELINE (1975)	897.224	CS BM MON IN WELL 9IN DN @ INT HACIENDA BLVD & SKYLINE DR 25FT W & 14FT N C/L INT MKD (BM- 38-6 1954)	CG 2591
BASELINE (1975)	791.615	RDBM TAG CONC HDWL OF DRAIN 36FT E APPROX C/L HACIENDA BLVD 0.3MI SLY INT HACIENDA BLVD & SKYLINE DR	CG 2593

JAD-YEAR	ELEV	D E S C R I P T I O N (INCLUDE QUAD AND YEAR IN DESCRIPTION)	BM NUMBER
BASELINE (1975)	785.884	CS MON 2IN UP @ PI OF OLD RD ON SEMI-TAN GOING SLY 12FT N TP NO W7302Y 30FT WLY C/L HACIENDA BLVD & 0.35MI SLY INT HACIENDA BLVD & SKYLINE DR USE S EDGE MKD (CO SUR RE 2177)	CG 2594
BASELINE (1975)	747.372	CS MON IN WELL 12IN DN 25FT E C/L HACIENDA BLVD & 4.6FT N C/L CANADA SOMBRA RD MKD (BM 38-5 1954)	CG 2595
BASELINE (1975)	495.706	L&T CONC RET WALL OF HSE ON NW COR HACIENDA BLVD & WEST RD 60FT NLY & 18FT WLY APPROX C/L INT	CG 2597
BASELINE (1975)	429.463	L&T S CB 1FT E BCR @ SE COR HACIENDA BLVD & JANINE DR 15FT S & 75FT E/O C/L INT	CG 2600
BASELINE (1975)	424.883	CS MON IN WELL 15IN DN ON C/L HACIENDA BLVD & 137FT S/O C/L JANINE DR @ INT OF ORANGE CO LINE	CG 2601
OTTRBEIN (1980)	477.158	RD BM TAG E CB 3FT S BCR @ SE COR COLIMA RD & PASO REAL AVE 80FT S & 18FT E C/L INT	CG 2611
TTRBEIN (1980)	477.139	RD BM TAG W CB 3FT S BCR @ SW COR COLIMA RD & PASO REAL AVE 80FT S & 18FT W C/L INT	CG 2612
OTTRBEIN (1980)	463.036	CITY OF INDUSTRY BR MON IN CB @ SE COR COLIMA RD & JELICK AVE 42FT S & 53FT E/O C/L INT MKD (BENCH MARK 5-9)	CG 2615
OTTRBEIN (1980)	462.325	RDBM TAG S CB 40FT W BCR @ SW COR COLIMA RD & JELICK AVE 42FT S & 94FT W C/L INT	CG 2616
OTTRBEIN (1980)	462.910	RD BM TAG N CB SERV ISL ON NE COR COLIMA RD & BATSON AVE 55FT N & 41FT E/O C/L INT	CG 2617
OTTRBEIN (1980)	463.941	CE BR MON IN CONC WK AROUND MH ON NW COR COLIMA RD & BATSON AVE 56FT N & 41FT W C/L INT MKD (BM 44-11A 1963 RE 5869)	CG 2618
OTTRBEIN (1980)	433.693	CITY OF INDUSTRY BR MON IN NW COR CONC FRAME AROUND GAS VALVES 30FT S/O C/L RAILROAD ST OPP BLDG #18451 & 0.25MI E/O C/L INT FULLERTON RD	CG 2625
OTTRBEIN (1980)	421.053	RDBM TAG W CB 1FT N BCR @ NW COR RAILROAD ST & LAWSON ST 45FT N & 18FT W INT	CG 2628
OTTRBEIN (1980)	418.693	CITY OF INDUSTRY BR MON W CB LAWSON ST 18FT W C/L & 472FT N/O INT RAILROAD ST MKD (BM 5-13)	CG 2629
BASELINE (1975)	576.910	RDBM TAG IN CONC FTG OF 5IN IP GUARD POST FOR 24IN WATER LINE 160FT E & 117FT S C/L INT VALLEY BLVD & BREA CANYON RD	CG 2684

JAD-YEAR	ELEV	D E S C R I P T I O N (INCLUDE QUAD AND YEAR IN DESCRIPTION)	BM NUMBER
BASELINE (1975)	548.200	FC BR MON FLUSH IN HDWL OF SPRR TRACK 81' S & 220' E/O APPROX C/L INT VALLEY BLVD & CARREY RD MKD (LACO FCD BM 102-18 1956)	CG 2685
BASELINE (1975)	545.083	LACS MON IN WELL 14IN DN @ INT 14FT NLY C/L VALLEY BLVD & 16FT WLY C/L PROD OF CARREY RD 300FT ELY C/L PIERRE RD MKD (BM 11-97 1952)	CG 2686
BASELINE (1975)	518.195	R D MON IN WELL 8IN DN DN C/L VALLEY BLVD & 100FT W C/L LEMON AVE MKD (LA CO RD DEPT 196)	CG 2688
BASELINE (1975)	515.492	FC BR DISK E END HDWL 1210FT W LEMON RD & 22FT N OF N RAIL SPRR 70FT S C/L VALLEY BLVD & 0.1MI E BOURDET AVE MKD (FCD BM 102-14 1956)	CG 2689
BASELINE (1975)	510.153	RDBM TAG IN N CB VALLEY BLVD 1FT E/O BCR @ NE COR CASTLEHILL RD & VALLEY BLVD 40FT N & 75FT E C/L INT	CG 2691
BASELINE (1975)	489.162	CS BR CAP @ NW COR CATCH BASIN 41FT S & 270FT E C/L INT VALLEY BLVD & CAMINO DE TEODORO MKD (BM 11-100A 1962)	CG 2692
BASELINE (1975)	470.750	R D MON IN WELL 8IN DN @ OR NR C/L INT VALLEY BLVD & SENTOUS AVE	CG 2693A
BASELINE (1975)	482.334	RDBM TAG NW COR OF 3X3FT CONC BASE OF BREATHER PIPE 58FT S C/L VALLEY BLVD & 700FT E SENTOUS AVE	CG 2694
BASELINE (1975)	398.485	CITY OF INDUSTRY BM BR MON FLUSH IN HDWL 40FT S C/L VALLEY BLVD & 18FT E C/L GIANO AVE MKD (NO V 26)	CG 2696
BASELINE (1975)	845.972	L&BN E CB WHITE AVE 1FT N BCR @ NE COR 2ND ST 61FT N & 42FT E C/L INT	CG 2787
BASELINE (1975)	900.686	L & T W CB EAST END AVE 2FT N BCR @ NW COR E FIRST ST 60FT N & 40FT W C/L INT	CG 2873
BASELINE (1975)	899.111	CS BR CAP MON FL 1FT S CF & 8FT W/O BCR S CB E FIRST ST @ SW COR EAST END AVE 84FT W & 21FT S C/L INT MKD (11-77-A 1959 CE RE 5869)	CG 2874
BASELINE (1975)	885.424	BR PLATE FL N END C B 30FT E C/L RESERVOIR ST 150FT N C/L E FIRST ST (MKD BM11-78A 1962 RE 5869)	CG 2876
BASELINE (1975)	876.842	L & BR E CB SAN ANTONIO AVE @ SE COR E FIRST ST 64FT S & 35FT E C/L INT	CG 2877

JAD-YEAR	ELEV	D E S C R I P T I O N (INCLUDE QUAD AND YEAR IN DESCRIPTION)	BM NUMBER
BASELINE (1975)	876.062	LACS BM MON FL @ SW ABUT OF BRIDGE OVER TOWNE AVE & 51FT W C/L 27FT S C/L FIRST ST MKD (CE BM 11-79A 1962 RE 5869)	CG 2878
BASELINE (1975)	823.714	CS MON IN WELL 8IN DN SW COR 2ND ST & OAK AVE 31FT S & 50FT W C/L INT MKD (BM 11-84A 1962)	CG 2955
BASELINE (1975)	850.539	CS BM MON FL IN HDWL 27FT S C/L FIRST ST & 84FT W WHITE AVE MKD (BM 11-83-A 1962 RE 5869)	CG 2956
BASELINE (1975)	332.877	CS MON FL IN C B ON SE COR HACIENDA BLVD & GALE AVE 22FT E/O BCR 42FT S & 105FT E/O C/L INT MKD (BM 38-13A 1963)	CG 2986
BASELINE (1975)	318.597	L&BN E CB 5FT N BCR @ SE COR VALLEY BLVD & HACIENDA BLVD 41FT E & 71FT S C/L INT MKD (BM)	CG 2987
BASELINE (1975)	318.253	RDBM TAG N CB 57FT E BCR @ NE COR VALLEY BLVD & HACIENDA BLVD 40FT N & 120FT E C/L INT	CG 2988
BASELINE (1975)	334.709	RDBM TAG W CB 1FT N BCR @ NW COR OLD VALLEY BLVD & ALBERT ST 46FT N & 18FT W C/L INT	CG 2989
BASELINE (1975)	342.317	LACS MON IN WELL 10IN DN ON C/L OLD VALLEY BLVD 420FT E C/L VALLEY BLVD OVER PASS USE E EDGE MKD (329)	CG 2990
BASELINE (1975)	353.910	RDBM TAG N CB NR W END C B 25FT N APPROX C/L N BARREL VALLEY BLVD NR INT OLD VALLEY BLVD 0.2MI W C/L FERRERO LN	CG 2992
BASELINE (1975)	376.384	RDBM TAG N CB VALLEY BLVD 40FT N C/L @ E END C B 175FT W/O APPROX C/L PROD ANAHEIM -PUENTE RD	CG 2993
BASELINE (1975)	402.542	CS BM MON IN WELL 8IN DN NE COR HACIENDA BLVD & HALLIBURTON RD 90FT N & 43FT E APPROX C/L INT MKD (BM 38-11A 1963)	CG 3095
BASELINE (1975)	436.196	CS BM MON IN WELL 8IN DN NW COR HACIENDA BLVD & TETLY ST 43FT W & 73FT N APPROX C/L INT MKD (BM 38-10A 1963)	CG 3096
BASELINE (1975)	553.855	CEBM MON FL IN CB ON SE COR HACIENDA BLVD & COLIMA RD 42FT S & 60FT E APPROX C/L INT MKD (BM 38-8A 1963)	CG 3097
BASELINE (1975)	491.180	RDBM TAG S CB 1FT E BCR @ SE COR HACIENDA BLVD & AVOCADO CREST 47FT E & 16FT S APPROX C/L INT	CG 3098
OTTRBEIN (1980)	645.558	RD BM TAG N CB 42FT N APPROX C/L COLIMA RD & 0.1MI E ALLENTON ST NEAR CREST OF HILL	CG 3099

IAD-YEAR	ELEV	DESCRIPTION (INCLUDE QUAD AND YEAR IN DESCRIPTION)	BM NUMBER
OTTRBEIN (1980)	648.681	RD BM TAG S CB 42FT S APPROX C/L COLIMA RD & 0.1MI E ALLENTON ST NEAR CREST OF HILL	CG 3100
OTTRBEIN (1980)	626.829	RD BM TAG W CB 3FT N BCR @ NW COR COLIMA RD & PUNTA DEL ESTE DR 75FT N & 20FT W APPROX C/L INT	CG 3101
OTTRBEIN (1980)	627.051	L&T NE CB RET 12FT W BCR @ NE COR COLIMA RD & PUNTA DEL ESTE DR 42FT N & 38FT E APPROX C/L INT	CG 3102
OTTRBEIN (1980)	509.857	RD BM TAG N CB 6FT W BCR @ NE COR COLIMA RD & OTTRBEIN AVE 42FT N & 50FT E APPROX C/L INT	CG 3103
OTTRBEIN (1980)	528.748	RD BM TAG W CB 3FT N BCR @ NW COR COLIMA RD & YBARRA DR 80FT N & 18FT W C/L INT	CG 3104
OTTRBEIN (1980)	529.272	RD BM TAG E CB 1FT S BCR @ NE COR COLIMA RD & YBARRA DR 80FT N & 18FT E APPROX C/L INT	CG 3105
OTTRBEIN (1980)	591.895	RD BM TAG W CB 1FT S BCR @ SW COR COLIMA RD & LAKE CYN RD 77FT S & 30FT W C/L INT	CG 3106
TTRBEIN (1980)	591.752	L&NAIL S CB NR BCR @ SE COR COLIMA RD & LAKE CYN RD 40FT S & 98FT E APPROX C/L INT	CG 3107
OTTRBEIN (1980)	583.194	RD BM TAG W CB 1FT N BCR @ NW COR COLIMA RD & CALBOURNE DR 80FT N & 18FT W C/L INT	CG 3108
OTTRBEIN (1980)	583.059	RD BM TAG E CB 1FT N BCR @ NE COR COLIMA RD & CALBOURNE DR 80FT N & 18FT E C/L INT	CG 3109
OTTRBEIN (1980)	733.285	L&T N CB 0.7FT W BCR @ NW COR DIAMOND BAR BLVD & FOUNTAIN SPRINGS RD 20FT N & 75FT W APPROX C/L INT	CG 3121
OTTRBEIN (1980)	854.939	RDBM TAG N CB 1FT W BCR @ NW COR PATHFINDER RD & EVERGREEN SPRINGS DR 40FT N & 52FT W APPROX C/L INT	CG 3130
OTTRBEIN (1980)	705.842	L&BN CONC FTG OF NLY GATE POST TO HSE NO 2360 FULLERTON RD 2.2 MI SLY OF COLIMA RD ABUT 25FT ELY/O APPROX C/L MKD (BM)	CG 3133
OTTRBEIN (1980)	611.389	RDBM TAG WLY CB 1FT NLY BCR @ NWLY COR PATHFIND- ER RD & BLANDFORD DR 75FT NLY & 20FT WLY APPROX C/L INT	CG 3137
TTRBEIN (1980)	616.050	CE TAG ELY CB 16FT S/O BCR SELY COR PATHFINDER RD & BLANDFORD DR 82FT SLY & 20FT ELY APPROX C/L INT	CG 3138

IAD-YEAR	ELEV	D E S C R I P T I O N (INCLUDE QUAD AND YEAR IN DESCRIPTION)	BM NUMBER
OTTRBEIN (1980)	613.912	L&BN E CB 27FT N/O ENT SW IND ELECT CO 18FT E/O C/L ALEXDALE LN & 312FT S/O INT AGUIRO ST FT OF PP # E64547Y	CG 3139
OTTRBEIN (1980)	600.239	RDBM TAG W CB 203FT N/O ENT TO SO-WEST IND ELECT CO 18FT W/O C/L ALEXDALE LANE 137FT S/O INT AGUIRO ST	CG 3140
OTTRBEIN (1980)	552.090	RE TAG S CB 1FT E BCR @ SE COR LYCOMING ST & PENARTH AVE 20FT S & 45FT E APPROX C/L INT	CG 3142
OTTRBEIN (1980)	550.936	RE TAG W CB 1FT S BCR @ SW COR LYCOMING ST & PENARTH AVE 50FT S & 18FT W APPROX C/L INT	CG 3143
OTTRBEIN (1980)	525.574	CS MON IN WELL 18IN DN @ PI OF LEMON AVE NR INT CURRIER RD MKD (PRC LINE LA PUENTE)	CG 3144
OTTRBEIN (1980)	498.551	RDBM TAG S CB NR BCR @ SE COR BREA CYN CUTOFF RD & WALNUT DR 20FT S & 60FT E APPROX C/L INT	CG 3145
OTTRBEIN (1980)	546.225	LS TAG 2760 W CB OTTERBEIN AVE 18FT W APPROX C/L ABOUT 30FT S C/L PROD VALENCIA AVE	CG 3148
OTTRBEIN (1980)	550.888	CE TAG N CB VALENCIA AVE C/L PROD ALEXDALE LN	CG 3149
BASELINE (1975)	858.794	USC&GS MON FL @ W END C B 40FT E & 20FT N C/L INT FIRST ST & GORDON ST (MKD Q36 861 RESET 67)	CG 3506
BASELINE (1975)	379.908	L & BN @ NE COR FTG OF RR SIGNAL 80FT S & 125FT W C/L INT VALLEY BLVD & AZUSA AVE	CG 3622
BASELINE (1975)	783.583	RDBM TAG 7FT E/O END CB 16FT S C/L POMONA BLVD & 40FT W C/L BELLEVUE AVE PROD	CG 3668
BASELINE (1975)	322.014	RDBM TAG IN W CB 3FT S BCR 52FT S & 42FT W C/L INT HACIENDA BLVD & PARRLOTT PL N/O BRIDGE OVER U P TRACKS	CG 3711
BASELINE (1975)	553.866	RDBM TAG IN N CB 35FT E BCR 40FT N & 114FT E C/L INT HACIENDA BLVD & COLIMA RD	CG 3712
BASELINE (1975)	600.741	RDBM TAG IN W CB 40FT S LY C/L HACIENDA BLVD ON C/L PROD RICHVIEW DR	CG 3713
BASELINE (1975)	714.689	L & BN IN CONC FTG 1FT N/O S END BRICK WALL (AUSTIN HOMES TR) @ 2231 HACIENDA BLVD 26FT N LY & 35FT W LY C/L INT HACIENDA BLVD & PVT RD 0.05MI S C/L CANADA SOMBRA RD	CG 3715
BASELINE (1975)	664.621	1/2IN PIPE IN WELL 11IN DN 12FT E & 20FT S C/L HACIENDA BLVD & REPASADO DR (USE BRAD IN CTR)	CG 3717

JAD-YEAR	ELEV	DESCRIPTION (INCLUDE QUAD AND YEAR IN DESCRIPTION)	BM NUMBER
BASELINE (1975)	605.162	LACS MON IN WELL 11IN DN @ C/L INT HACIENDA BLVD & ENCANADA DR	CG 3718
BASELINE (1975)	495.576	L & BR IN COR HDWL 20FT S & 10FT E C/L INT WEST RD & HACIENDA BLVD	CG 3719
BASELINE (1975)	446.330	RAMSET @ BCR 50FT NLY & 83FT ELY C/L INT ESEVERRI LN & HACIENDA BLVD SERVICE RD	CG 3721
BASELINE (1975)	331.816	USGS MON FL IN VERT WALL @ NW COR BLDG 30FT S OLD VALLEY BLVD & 5FT W C/L PROD 1ST ST MKD (331)	CG 3722
BASELINE (1975)	362.464	LACS CONTROL SYS MON FL IN CTR CONC HDWL 64FT S C/L S BBL VALLEY BLVD & 390FT E C/L FERRERO LN 10FT N/O N RAIL SPRR MKD (H-11 RM NO 1 1958)	CG 3724
BASELINE (1975)	390.884	LACS MON FL 77FT S & 18FT W C/L INT VALLEY BLVD & HAMBLEDON AVE MKD (PUENTE J-11)	CG 3726
BASELINE (1975)	397.862	RDBM TAG IN CB 5FT W BCR 40FT N & 48FT W C/L INT VALLEY BLVD & GIANO AVE	CG 3727
BASELINE (1975)	426.752	LACS TRAV STA MON 4IN DN 75FT S & 439FT E C/L INT VALLEY BLVD & LA SEDA RD 15FT N/O N RAIL OF SPRR MKD (COVINA A-12 RESET 1966)	CG 3728
BASELINE (1975)	470.493	RDBM TAG @ B/W 59FT N & 53FT W C/L INT SENTOUS AVE & VALLEY BLVD	CG 3730
BASELINE (1975)	507.954	CITY OF INDUSTRY BR MON IN N CB 2FT W/O BCR 42FT N & 73FT W C/L INT VALLEY BLVD & CASTLEHILL DR MKD (V 40)	CG 3732
BASELINE (1975)	519.399	RDBM TAG IN W CB 5FT S BCR 78FT N & 42FT W C/L INT VALLEY BLVD & LEMON AVE	CG 3733
BASELINE (1975)	529.598	RDBM TAG IN NW LY COR CONC BASE OF RR SIGNAL BOX 0.3MI E LY C/L LEMON AVE & 100FT S LY CTR MAC PVMT ON VALLEY BLVD 11FT S/O S RAIL SPRR	CG 3734
BASELINE (1975)	543.024	RDBM TAG NR CTR BCR 65FT N LY & 30FT W LY C/L INT VALLEY BLVD & PIERRE RD	CG 3735
BASELINE (1975)	564.489	RDBM TAG IN NW LY COR CONC BASE RR SIGNAL NO A 0.3MI ELY CARREY RD 89FT SLY VALLEY BLVD 7.5FT S/O S RAIL SPRR	CG 3736
BASELINE (1975)	575.810	LACS MON IN WELL 12IN DN 155FT NLY & 21FT WLY C/L INT VALLEY BLVD & NEW C/L BREA CYN RD	CG 3737

AD-YEAR	ELEV	DESCRIPTION (INCLUDE QUAD AND YEAR IN DESCRIPTION)	BM NUMBER
BASELINE (1975)	585.748	CITY OF INDUSTRY BR MON IN N END HDWL 34FT S LY C/L VALLEY BLVD & 0.25MI N BREA CYN RD MKD V-90	CG 3738
BASELINE (1975)	709.764	RDBM TAG IN N CB 32FT N C/L POMONA BLVD 0.2MI NE TEMPLE AVE @ WLY EDGE OF W DRWY APRON TO REVERE EXTRUDERS INC 3255 POMONA BLVD	CG 3743
BASELINE (1975)	725.241	LACS MON 11IN DN 4FT OFF EDGE CONC 24FT NLY C/L POMONA BLVD 0.55MI ELY TEMPLE AVE 94FT WLY C/L NO 57 FWY MKD (COVINA L)	CG 3744
BASELINE (1975)	751.511	RDBM TAG IN CB 3FT SW LY FROM END 32FT NW LY C/L OPPOSITE BLDG NO 2660 POMONA BLVD 1.0MI ELY C/L TEMPLE AVE	CG 3746
BASELINE (1975)	753.306	RDBM TAG IN CB 5FT SW END CB 32FT SE LY C/L POMONA BLVD OPPOSITE BLDG NO 2660 1MI NE TEMPLE	CG 3747
BASELINE (1975)	758.262	LACS TRI STA MON 12IN DN 34FT NW LY C/L 10FT S/O ENTRANCE TO NO 2640 POMONA BLVD 1.15MI N/O TEMPLE AVE MKD (CLAREMONT A-6B 1939)	CG 3748
BASELINE (1975)	770.875	RDBM TAG IN CONC FTG PUMP CONTROL BOX 59FT N/O N RAIL SPRR 20FT S LY & 30FT W LY C/L INT RIDGEWAY ST & MT VERNON AVE	CG 3749
BASELINE (1975)	809.929	RDBM TAG IN N EDGE CONC HDWL 155FT S & 47FT E C/L INT 2ND ST & HWY NO 71	CG 3751
BASELINE (1975)	814.185	RDBM TAG IN CB 7FT W/O BOX CULV 23FT N C/L 2ND ST & 110FT W/O SPRR TRACKS 0.25MI W C/L OAK AVE	CG 3752
BASELINE (1975)	814.207	RDBM TAG IN CB 6FT W BOX CULV 23FT S/O C/L 2ND ST & 110FT W/O RR TRACKS 0.25MI W/O C/L OAK AVE	CG 3753
BASELINE (1975)	825.002	RDBM TAG IN S CB 1FT E BCR 28FT S & 55FT E C/L INT 2ND ST & OAK AVE	CG 3754
BASELINE (1975)	836.480	RDBM TAG IN S CB 8FT W BCR 23FT S & 50FT W C/L INT 2ND ST & HAMILTON BLVD	CG 3755
BASELINE (1975)	837.615	RDBM TAG IN E CB 18FT N BCR 45FT N & 35FT E C/L INT 2ND ST & HAMILTON BLVD	CG 3756
BASELINE (1975)	845.723	RDBM TAG IN W CB 2FT S BCR 65FT S & 32FT W C/L INT 2ND ST & WHITE AVE	CG 3757
BASELINE (1975)	851.169	RDBM TAG IN S CB 30FT E BRIDGE ABUT 21FT S & 77FT E C/L INT FIRST ST & WHITE AVE	CG 3758
BASELINE (1975)	859.155	RDBM TAG IN N CB 20FT N & 5FT E C/L INT 1ST ST & S GORDON ST	CG 3759

JAD-YEAR	ELEV	DESCRIPTION (INCLUDE QUAD AND YEAR IN DESCRIPTION)	BM NUMBER
BASELINE (1975)	857.253	RDBM TAG IN E CB 35FT S & 24FT E C/L INT 1ST ST & S GORDON ST	CG 3760
BASELINE (1975)	868.168	RDBM TAG N CB 5FT W/O BCR 20FT N & 60FT W C/L INT FIRST ST & PALOMARES ST	CG 3761
BASELINE (1975)	868.933	RDBM TAG IN S CB 1FT E BCR 20FT S & 59FT E C/L INT 1ST ST & PALOMARES ST	CG 3762
BASELINE (1975)	875.599	L & PK IN E END WINGWALL OF BRIDGE OVER TOWNE AV 26FT S & 79FT E C/L INT 1ST ST & TOWNE AVE	CG 3763
BASELINE (1975)	878.255	RDBM TAG IN N CB 6FT W/O END 20FT N & 72FT W C/L INT 1ST ST & SAN ANTONIO AVE	CG 3764
BASELINE (1975)	884.056	RDBM TAG IN N CB 20FT N & 92FT W C/L INT 1ST ST & RESERVOIR ST	CG 3765
BASELINE (1975)	883.319	RDBM TAG IN S CB 2FT E BCR 20FT S & 59FT E C/L INT 1ST ST & RESERVOIR ST	CG 3766
BASELINE (1975)	889.301	RDBM TAG IN CB 20FT S C/L 1ST ST @ E P/L WATER RESERVOIR 286FT E INT ELECTRA ST	CG 3767
OTTRBEIN (1980)	537.771	RDBM TAG IN CB 5FT E BCR 20FT S & 50FT E C/L INT LYCOMING ST & GLENWICK AVE	CG 3801
OTTRBEIN (1980)	561.128	RDBM TAG IN CB 13FT W BCR 20FT S & 60FT W C/L INT LYCOMING ST & OLD BREA CYN RD	CG 3802
OTTRBEIN (1980)	580.272	RDBM TAG IN CB 34FT N BCR 42FT W & 125FT N C/L INT OLD BREA CYN RD & COLIMA RD	CG 3803
OTTRBEIN (1980)	874.143	RDBM MON IN WELL 8IN DN 85FT N & 30FT W C/L INT EAST RD & SKYLINE DR 2IN IP 3FT UP 1FT W	CG 3807
OTTRBEIN (1980)	549.396	L & T IN CB 10FT N BCR 65FT N & 30FT E C/L INT FULLERTON RD & SENTENO ST	CG 3808
OTTRBEIN (1980)	534.583	LACE TAG IN CB 40FT S & 32FT W/O C/L INT MESCAL ST & FULLERTON RD	CG 3809
OTTRBEIN (1980)	516.155	L & CE TAG NO 10915 IN CB 1FT N BCR 55FT N & 32FT W/O C/L INT FULLERTON RD & GALATINA ST	CG 3810
OTTRBEIN (1980)	476.134	L & T IN CB 5FT N BCR 71FT S & 32FT W C/L INT COLIMA RD & FULLERTON RD MKD (BM)	CG 3812
OTTRBEIN (1980)	473.023	L & T IN CB 6FT W BCR 42FT N & 59FT E C/L INT COLIMA RD & FULLERTON RD TO THE N MKD (BM)	CG 3813

AD-YEAR	ELEV	DESCRIPTION (INCLUDE QUAD AND YEAR IN DESCRIPTION)	BM NUMBER
OTTRBEIN (1980)	440.691	RAMSET NR MCR 26FT S & 28FT E C/L INT JELLYCK AVE & GREENBAY DR	CG 3814
OTTRBEIN (1980)	426.705	L&PK IN CB 20FT N/O C/L RAILROAD ST & 396FT W/O INT FULLERTON RD IN FRONT OF BLDG NO 18233	CG 3815
OTTRBEIN (1980)	421.336	RDBM TAG IN CB 10FT E BCR 20FT N & 77FT E C/L INT RAILROAD ST & LAWSON ST	CG 3816
OTTRBEIN (1980)	419.925	CITY OF INDUSTRY BR MON FLUSH @ C/L INT LAWSON ST & ROWLAND ST MKD (RE 5828)	CG 3817
OTTRBEIN (1980)	393.523	L & BN IN CONC FTG OF GATE POST 58FT E C/L LAWSON ST & 13FT S/O LA FC CHANNEL WALL MKD (BM)	CG 3818
OTTRBEIN (1980)	392.868	L & BN IN CONC FTG OF FENCE POST 66FT W C/L LAWSON ST & 13FT S LAFC CHANNEL WALL	CG 3819
OTTRBEIN (1980)	601.417	RDBM TAG IN NE COR C B 46FT N & 70FT W C/L INT COLIMA RD & STIMSON AVE	CG 3822
OTTRBEIN (1980)	581.957	RDBM TAG IN CB 42FT N C/L COLIMA RD & 0.25MI E PUNTA DEL ESTE DR 400FT W/O COUNTY CYN RD	CG 3824
OTTRBEIN (1980)	489.564	RDBM TAG IN CONC CB 42FT S/O C/L COLIMA RD & 65FT E/O COUNTRYWOOD RD	CG 3825
OTTRBEIN (1980)	490.983	RDBM TAG IN CONC CB 8FT E/O BCR 42FT N/O C/L COLIMA RD & 74FT E/O COUNTRYWOOD RD	CG 3826
OTTRBEIN (1980)	465.296	RDBM TAG IN CB 4FT N BCR 75FT N & 20FT W C/L INT COLIMA RD & PARKLAWN RD	CG 3827
OTTRBEIN (1980)	456.874	RDBM TAG IN CB 6FT W/O CB END 42FT S & 81FT W C/L INT COLIMA RD & AZUSA AVE	CG 3829
OTTRBEIN (1980)	587.295	RDBM TAG IN E EDGE C B 43FT S C/L COLIMA RD & 0.25MI E PUNTA DEL ESTE DR 475FT W/O C/L COUNTRY CYN DR	CG 3832
OTTRBEIN (1980)	530.076	RDBM TAG IN C B 18FT E C/L PASO VERDE DR & 51FT S C/L CLEMINTINA DR	CG 3833
OTTRBEIN (1980)	526.246	RDBM TAG IN CB 3FT E BCR 18FT N & 48FT E C/L INT CLEMINTINA DR & PASO VERDE DR	CG 3834
OTTRBEIN (1980)	406.746	RE TAG #5406 CTR CONC WK @ MC 30FT S/O C/L GLENELDER AVE & 31FT E/O C/L WEDGEWORTH DR	CG 3836

JAD-YEAR	ELEV	DESCRIPTION (INCLUDE QUAD AND YEAR IN DESCRIPTION)	BM NUMBER
OTTRBEIN (1980)	405.794	RE TAG # 5406 CTR CONC WK @ MC & HSE # 16242 30FT W/O C/L WEDGEWORTH DR & 30FT N/O C/L FLAMSTEAD DR	CG 3837
OTTRBEIN (1980)	381.899	RDBM TAG IN CB 4FT N BCR 42FT S ^{LY} & 15FT E ^{LY} C/L INT EASTLEIGH AVE & SIGMAN ST	CG 3838
OTTRBEIN (1980)	380.427	RDBM TAG IN CB @ E END C B 18FT N ^{LY} & 64FT W ^{LY} C/L INT SIGMAN ST & EASTLEIGH AVE	CG 3839
OTTRBEIN (1980)	425.900	L&BN IN CB 24FT S BCR 111FT S & 35FT W C/L INT STIMSON AVE & HALLIBURTON RD	CG 3842
OTTRBEIN (1980)	436.648	RDBM TAG IN CB 24FT S BCR 90FT S & 40FT W C/L INT AZUSA AVE & POMONA FRWY OFF RAMP (E BOUND)	CG 3843
OTTRBEIN (1980)	377.715	RDBM TAG IN SW COR C B 43FT E AZUSA AVE & 433FT N RAILROAD AVE	CG 3847
OTTRBEIN (1980)	721.807	RDBM TAG IN W EDGE CONC DR TO FIRE STA 24FT N C/L DEEP CYN RD & 145FT W C/L EAST RD	CG 3849
OTTRBEIN (1980)	730.077	RDBM TAG IN S CB EXIT DRWY TO HACIENDA GOLF CLUB 0.3 MI E/O WLY INT CHURCHILL RD 20FT SWLY/O C/L EAST RD 2FT S/O CB END	CG 3850
OTTRBEIN (1980)	619.851	RD BM TAG IN CB 0.2 MI W/O WLY INT CHURCH-HILL RD 15FT W/O C/L EAST RD 25FT S/O END OF CB & 85FT S/O DR TO HSE NO 365 EAST RD	CG 3851
OTTRBEIN (1980)	469.035	RDBM TAG IN CB 5FT W/O CB END 42FT S & 36FT W C/L INT COLIMA RD & DESIRE AVE	CG 3854
OTTRBEIN (1980)	469.592	L & RCE TAG # 10915 IN CB 1FT E/O BCR 42FT N & 79FT E/O C/L INT COLIMA RD & DESIRE AVE	CG 3855
OTTRBEIN (1980)	486.260	RDBM TAG IN CONC CB 38FT N BCR 112FT N & 42FT E/O C/L INT COLIMA RD & NOGALES ST	CG 3856
OTTRBEIN (1980)	488.118	RDBM TAG IN CB 2FT W/O BCR 78FT E & 46FT S/O C/L INT NOGALES ST & COLIMA RD	CG 3857
OTTRBEIN (1980)	511.005	RDBM TAG IN CB 6FT E BCR 42FT S & 62FT E C/L INT COLIMA RD & OTTERBIEN AVE	CG 3858
OTTRBEIN (1980)	523.241	L & LS TAG # 2825 IN CB 42FT S/O C/L COLIMA RD & 398FT E/O C/L BANIDA AVE 15FT W/O PP # 1654178E	CG 3859
OTTRBEIN (1980)	574.496	RDBM TAG IN CB 6FT W FUT BCR 43FT N & 37FT E C/L INT COLIMA RD & HALLGREEN DR	CG 3861

JAD-YEAR	ELEV	DESCRIPTION (INCLUDE QUAD AND YEAR IN DESCRIPTION)	BM NUMBER
OTTRBEIN (1980)	597.336	L & T IN CB 15FT N BCR 66FT S & 22FT W C/L INT COLIMA RD & WALNUT LEAF DR	CG 3862
OTTRBEIN (1980)	596.163	RDBM TAG IN CB 7FT E BCR 42FT S & 63FT E C/L INT COLIMA RD & WALNUT LEAF DR	CG 3863
OTTRBEIN (1980)	566.823	L & LS TAG NO 3054 IN CB 1FT N BCR 80FT N & 18FT W C/L INT COLIMA RD & ARKLEY DR	CG 3864
OTTRBEIN (1980)	568.792	L & LS TAG NO 3054 IN CB 1FT W FUT BCR 42FT N & 54FT E C/L INT COLIMA RD & ARKLEY DR	CG 3865
OTTRBEIN (1980)	498.683	RDBM TAG IN CB 3FT S BCR 48FT S & 20FT W C/L INT WALNUT DR & BREA CYN CUTOFF RD	CG 3868
OTTRBEIN (1980)	518.932	L & LS TAG NO 3054 IN CB 20FT W C/L BREA CYN CUT-OFF RD @ S P/L HSE NO 1337 127FT N/O C/L SEARLS DR	CG 3869
OTTRBEIN (1980)	522.192	L & BN IN CONC FTG 6FT STEEL FENCE POST @ SW COR YBARRA SCHOOL YARD 30FT E/O C/L BR A CYN CUT-OFF RD & 47FT S/O C/L SEARLS DR	CG 3870
OTTRBEIN (1980)	623.168	RDBM TAG IN CB 84FT N & 20FT W C/L INT GALLIO AVE & PATHFINDER RD	CG 3872
OTTRBEIN (1980)	623.199	RDBM TAG IN CB 84FT N & 20FT E C/L INT GALLIO AVE & PATHFINDER RD	CG 3873
OTTRBEIN (1980)	578.646	RDBM TAG IN W END C B 41FT S/O C/L PATHFINDER RD 1128FT E/O INT BLANDFORD DR	CG 3875
OTTRBEIN (1980)	580.382	LACE TAG E END C B 41FT N/O C/L PATHFINDER RD 1145FT E/O INT BLANDFORD DR MKD (BM 11-78A- 1962)	CG 3876
OTTRBEIN (1980)	591.145	LACE TAG W CB 1FT N/O BCR 115FT N & 20FT W C/L INT PASO REAL AVE & PATHFINDER RD (AGUIRO ST)	CG 3877
OTTRBEIN (1980)	592.049	RDBM TAG IN CB 2FT N BCR 91FT N & 20FT E C/L INT PATHFINDER RD & PASO REAL AVE	CG 3878
OTTRBEIN (1980)	606.797	RDBM TAG SO CB BALAN RD 18FT S/O C/L & 176FT E/O INT EDMORE AVE	CG 3880
OTTRBEIN (1980)	607.012	L&BR NO CB BALAN RD 18FT N/O C/L & 180FT E/O INT EDMORE AVE	CG 3881
OTTRBEIN (1980)	523.921	LACS MON IN WELL 6IN DN @ C/L INT KILLIAN AVE OTTRBIEN AVE (USE S EDGE)	CG 3891

JAD-YEAR	ELEV	DESCRIPTION (INCLUDE QUAD AND YEAR IN DESCRIPTION)	BM NUMBER
OTTRBEIN (1980)	742.698	RDBM TAG IN N EDGE C B 65FT S & 42FT W C/L INT GOLDEN SPRINGS DR & GRAND AVE	CG 3900
OTTRBEIN (1980)	736.459	RDBM TAG IN CB 1FT E BCR 32FT N & 80FT E C/L INT GOLDEN SPRINGS DR & GRAND AVE	CG 3901
OTTRBEIN (1980)	751.382	RDBM TAG IN W EDGE C B 33FT S/O C/L GOLDEN SPRINGS DR & 0.5MI E/O GRAND AVE	CG 3902
OTTRBEIN (1980)	749.583	RDBM TAG IN W EDGE C B 33FT N/O C/L GOLDEN SPRINGS DR & 0.5MI E/O GRAND AVE	CG 3903
OTTRBEIN (1980)	750.790	RDBM TAG IN W EDGE C B 33FT S & 18FT W C/L INT GOLDEN SPRINGS DR & SABANA DR	CG 3904
OTTRBEIN (1980)	753.292	RDBM TAG IN CB 6FT E BCR 32FT N & 57FT E C/L INT GOLDEN SPRINGS DR & SABANA DR	CG 3905
OTTRBEIN (1980)	744.391	L & BR IN CB 2FT E BCR 16FT SLY & 72FT WLY C/L INT DIAMOND BAR BLVD & COLD SPRING LANE	CG 3906
OTTRBEIN (1980)	744.630	RDBM TAG IN CB 38FT N'LY BCR 97FT N'LY & 40FT WLY C/L INT DIAMOND BAR BLVD & COLD SPRING LANE	CG 3907
OTTRBEIN (1980)	813.614	L & RCE TAG NO 8793 1.5FT N BCR 53FT S & 50FT W C/L INT DIAMOND BAR BLVD & KIDWA CREST DR	CG 3908
OTTRBEIN (1980)	826.580	L & LS TAG NO 2602 IN CB 1FT W BCR 18FT N'LY & 76FT W'LY C/L INT DIAMOND BAR BLVD & ACACIA HILL ROAD	CG 3909
OTTRBEIN (1980)	895.574	L & T IN E END C B 44FT S & 96FT W C/L INT GRAND AVE & DIAMOND BAR BLVD (MKD BM C-12)	CG 3911
OTTRBEIN (1980)	895.980	L & T IN E END C B 43FT N & 96FT W C/L INT GRAND AVE & DIAMOND BAR BLVD (MKD BM C-11)	CG 3912
OTTRBEIN (1980)	813.974	RDBM TAG IN CB @ FIRE PLUG 48FT W C/L DIAMOND BAR BLVD & 0.15MI S'LY GOLDEN SPRINGS DR	CG 3915
OTTRBEIN (1980)	694.931	RDBM TAG IN CB 34FT E BCR 25FT S & 100FT E C/L INT DIAMOND BAR BLVD & SUNSET CROSSING RD	CG 3918
OTTRBEIN (1980)	872.750	S & L IN CB 5FT S BCR 20FT WLY & 82FT SLY C/L INT DIAMOND BAR BLVD & SOLTAIRE ST	CG 3922
OTTRBEIN (1980)	876.082	RDBM TAG IN CB 2FT S BCR 53FT ELY & 42FT SLY C/L INT DIAMOND BAR BLVD & SOLTAIRE ST	CG 3923
OTTRBEIN (1980)	795.939	RDBM TAG IN N END CONC HDWL 115FT N'LY & 95FT E'LY C/L INT MISSION BLVD & CORONA EXPRESSWAY	CG 3926

JAD-YEAR	ELEV	DESCRIPTION (INCLUDE QUAD AND YEAR IN DESCRIPTION)	BM NUMBER
OTTRBEIN (1980)	677.885	RDBM TAG IN CB 2FT W BCR 32FT N'LY & 55FT E'LY C/L INT SUNSET CROSSING RD & OLD TRAIL RD	CG 3927
OTTRBEIN (1980)	674.964	RDBM TAG IN CB 4FT W BCR OF ALLEY 32FT S'LY & 28FT W'LY C/L INT SUNSET CROSSING RD & OLD TRAIL ROAD	CG 3928
OTTRBEIN (1980)	650.493	L & LS TAG NO 2825 IN CB 32FT N'LY & 26FT W'LY C/L INT SUNSET CROSSING RD & BIG FALLS DR	CG 3929
OTTRBEIN (1980)	647.922	L & LS TAG NO 2825 IN CB 3FT E BCR OF ALLEY 32FT S'LY & 153FT W'LY C/L INT SUNSET CROSSING RD & BIG FALLS DR	CG 3930
OTTRBEIN (1980)	852.029	L & BR IN S CB SERVICE RD 1FT E BCR OF ISLAND 52FT N 34FT E C/L INT PATHFINDER RD & EVERGREEN SPRINGS DR	CG 3931
OTTRBEIN (1980)	856.354	L & BR 1FT W BCR 36FT N & 51FT E C/L INT FERN HOLLOW DR & PATHFINDER RD	CG 3932
OTTRBEIN (1980)	853.552	L & BR IN CB 5FT N BCR @ C B 71FT N & 18FT W C/L FERN HOLLOW DR & PATHFINDER RD	CG 3933
OTTRBEIN (1980)	397.145	CITY OF INDUSTRY BR MON IN CB 4FT W BCR 32FT S & 78FT W C/L INT AZUSA AVE & GALE AVE MKD (G-10A BM)	CG 4035
OTTRBEIN (1980)	436.808	L&T CTR CB RET 60FT E & 46FT S/O INT AZUSA AVE & POMONA FRWY EAST BOUND OFF RAMP	CG 4037
OTTRBEIN (1980)	455.858	RD BM TAG 6FT S/O BCR @ NW COR AZUSA AVE & COLIMA RD 88FT N & 42FT W/O C/L INT	CG 4038
OTTRBEIN (1980)	456.383	RD BM TAG 4FT N/O BCR @ NE COR AZUSA AVE & COLIMA RD 109FT N & 60FT E/O C/L INT	CG 4039
OTTRBEIN (1980)	464.442	RD BM TAG 7FT W/O BCR @ NE COR COLIMA RD & ENT TO ROBINSONS PARKING LOT (LA PUENTE SHOPPING CTR) 2FT S/O ST LITE NO 2026482E 55FT E & 43FT N/O C/L INT 0.1 MI E/O AZUSA AVE	CG 4040
OTTRBEIN (1980)	456.195	CITY OF INDUSTRY MON @ SE COR C B 14FT E & 46FT S/O C/L INT COLIMA RD & ALBATROSS ST MKD (BM CO-2)	CG 4041
OTTRBEIN (1980)	455.316	RD MON IN WELL 6IN DN ON C/L COLIMA RD 254FT E/O C/L INT ALBATROSS ST MKD (1974)	CG 4042

IAD-YEAR	ELEV	DESCRIPTION (INCLUDE QUAD AND YEAR IN DESCRIPTION)	BM NUMBER
OTTRBEIN (1980)	448.840	CITY OF INDUSTRY MON FL IN SE COR C.B 4FT S/O S CB & 46FT S/O C/L COLIMA RD & 0.55 MI W/O LARKVANE RD & 125FT W/O C/L WALNUT HALL RD MKD (BM CO - 4)	CG 4044
OTTRBEIN (1980)	487.003	RD BM TAG 2FT E/O BCR @ SE COR COLIMA RD & LARKVANE RD 46FT E & 45FT S/O C/L INT	CG 4046
BASELINE (1975)	372.725	RDBM TAG IN CONC CB 40FT S C/L VALLEY BLVD & 20FT W C/L PROD WICKFORD AVE	CG 4090
BASELINE (1975)	379.368	CS MON @ E END CONC HDWL 62FT S C/L VALLEY BLVD & 124FT E C/L PROD AZUSA WAY 10FT N/O SPRR RAILS MKD (BM 11-106B 1971)	CG 4091
BASELINE (1975)	403.631	LACS (BM 11-0104A) MON DN 6IN 117FT S C/L VALLEY BLVD & 700FT E GIANO AVE 5FT S/O S RAIL SPRR DUE S OF CTR OF HDWL MKD (1-12 1958)	CG 4092
BASELINE (1975)	429.768	CITY OF INDUSTRY BM MON FL @ E END CONC HDWL 70FT S C/L VALLEY BLVD & 0.2MI E LA SEDA RD MKD (U-30)	CG 4093
BASELINE (1975)	577.582	LAFC DISC IN N WALL OF FC CHANNEL 5FT E/O NE COR OF BRIDGE 110FT S & 22FT E C/L INT VALLEY BLVD & BREA CANYON RD MKD (BM 103-00005)	CG 4094
BASELINE (1975)	606.239	CS MON IN WELL 8IN DN 55FT WLY & 78FT NLY C/L INT VALLEY BLVD & GRAND AVE @ PI OF VALLEY BLVD	CG 4095
BASELINE (1975)	648.194	L&T IN S CB VALLEY BLVD 42FT S & 0.55MI E GRAND AVE 5FT S/O PI MON NR E P/L OF BLDG NO 22040	CG 4096
BASELINE (1975)	648.705	L&T IN MEDIAN CB 7FT S C/L VALLEY BLVD & 0.55MI E GRAND AVE OPP PI MON NR E P/L OF BLDG NO 22040	CG 4097
BASELINE (1975)	652.559	RDBM TAG IN NLY WALL C B VALLEY BLVD 42FT ELY & 1.0MI NLY C/L GRAND AVE 62FT NLY N DR TO TELEDYNE BLDG NO 4200	CG 4098
BASELINE (1975)	656.851	RDBM TAG IN NLY WALL OF C B 42FT WLY C/L VALLEY BLVD & 1.0MI NLY OF C/L GRAND AVE & 247FT NLY OF N DR TO TELEDYNE BLDG # 4200	CG 4099
BASELINE (1975)	675.734	L&T IN ELY CB VALLEY BLVD @ S ELY END OF FC BRIDGE OVER SAN JOSE WASH 42FT ELY & 1.3MI N ELY GRAND AVE	CG 4100
BASELINE (1975)	675.130	L&T IN WLY CB VALLEY BLVD @ N WLY END OF FC BRIDGE OVER SAN JOSE WASH 42FT WLY & 1.3MI N ELY GRAND AVE	CG 4101

DATE-YEAR	ELEV	DESCRIPTION (INCLUDE QUAD AND YEAR IN DESCRIPTION)	BM NUMBER
BASELINE (1975)	684.009	L&T IN CB 3FT S WLY C B 40FT NLY C/L VALLEY BLVD & 8FT ELY C/L POMONA BLVD 25FT ELY C/L DRIVEWAY INTO TRAILER PARK	CG 4102
BASELINE (1975)	686.227	L&T 4FT WLY BCR OF NOSE OF ISL 78FT SLY C/L VALLEY BLVD NR C/L PROD POMONA BLVD 86FT WLY INT SPRR TRACKS & POMONA BLVD	CG 4103
BASELINE (1975)	704.857	L&T @ MCR NE COR POMONA BLVD & TEMPLE AVE 39FT N/O C/L POMONA BLVD & 51FT E/O C/L TEMPLE AVE	CG 4104
BASELINE (1975)	704.844	L&T @ MCR @ SE COR POMONA BLVD & TEMPLE AVE 57FT E/O C/L TEMPLE AVE & 83FT S/O C/L POMONA BLVD	CG 4105
BASELINE (1975)	729.056	RDBM TAG CONC CB 2FT E/O BCR 32FT S C/L POMONA BLVD & 33FT E C/L DR BLDG NO 2882 179FT E C/L NO 57 FWY	CG 4106
BASELINE (1975)	603.553	CSBM MON FL IN NLY WALL C B 41FT WLY C/L HACIENDA BLVD & 40FT SLY C/L PROD RICHVIEW DR MKD (BM 38-7A 1975)	CG 4107
BASELINE (1975)	813.843	L&BN IN NE COR CONC HDWL 20FT W C/L HACIENDA BLVD & 0.55MI S C/L RICHVIEW DR	CG 4109
BASELINE (1975)	492.674	RDBM TAG IN W WALL C B 36FT E/O BCR @ SE COR AVACADO CREST RD & HACIENDA BLVD 18FT S & 78FT E C/L INT	CG 4112
BASELINE (1975)	357.510	L&BN E END CONC HDWL 88FT S C/L VALLEY BLVD 0.1MI W C/L FERRERO LN 5FT N/O N RAIL SPRR NR INT OF OLD VALLEY BLVD	CG 4144
OTTRBEIN (1980)	693.304	RDBM TAG 4FT S BCR @ NE COR DIAMOND BAR BLVD & SUNSET CROSSING RD 54FT N & 44FT E C/L INT	CG 4195
OTTRBEIN (1980)	724.322	RAM SET 1FT BACK OF CB 1FT N BCR @ NE COR DIAMOND BAR BLVD & PALOMINO DR 55FT N & 46FT E/O C/L INT	CG 4196
OTTRBEIN (1980)	726.175	RDBM TAG 34FT S BCR @ SW COR DIAMOND BAR BLVD & PALOMINO DR 75FT S & 51FT W C/L INT NLY WALL C B	CG 4197
OTTRBEIN (1980)	679.449	RDBM TAG 1FT S BCR @ NW COR BREA CANYON RD & DIAMOND BAR BLVD 70FT N & 32FT W C/L INT	CG 4198
OTTRBEIN (1980)	679.637	RDBM TAG 1FT W BCR @ SW COR BREA CANYON RD & DIAMOND BAR BLVD 42FT S & 105FT W C/L INT	CG 4199

IAD-YEAR	ELEV	DESCRIPTION (INCLUDE QUAD AND YEAR IN DESCRIPTION)	BM NUMBER
OTTRBEIN (1980)	511.013	LACE BM MON DISK 1FT S/O CB @ E END C B 43FT S & 60FT E/O C/L INT COLIMA RD & OTTERBEIN AVE MKD (BM 44-9B RE 7078 1971)	CG 4201
OTTRBEIN (1980)	503.522	RD BM TAG 1FT S/O BCR @ SW COR FULLERTON RD & CROSSHAVEN DR 45FT S & 32FT W/O C/L INT	CG 4202
OTTRBEIN (1980)	533.061	RD BM TAG 1FT N/O BCR @ NW COR FULLERTON RD & MESCAL ST 43FT N & 32FT W/O C/L INT	CG 4203
OTTRBEIN (1980)	611.072	RD BM TAG N END OF C B @ N ENT TO ROWLAND WATER DIST 0.5 MI S/O SENTENO ST & 18FT W/O CENTER OF TRAVEL FULLERTON RD	CG 4204
OTTRBEIN (1980)	867.525	RD BM TAG 1FT N/O BCR NE COR EAST RD & SKYLINE DR 40FT NLY & 13FT ELY/O C/L INT	CG 4205
OTTRBEIN (1980)	581.412	CSBM MON FLUSH IN CONC BASE VENT PIPE 7FT N/O BCR @ NW COR BREA CYN RD & COLIMA RD 100FT N & 45FT W/O C/L INT MKD (BM 44-4A 1971)	CG 4206
OTTRBEIN (1980)	642.116	RAM SET CTR CB RET @ NE COR BREA CYN RD & VIA SORELLA 46FT E & 32FT N/O C/L INT	CG 4207
OTTRBEIN (1980)	643.518	RAM SET 2FT W/O BCR @ SE COR BREA CYN RD & VIA SORELLA 46FT E & 38FT S/O C/L INT	CG 4208
OTTRBEIN (1980)	737.860	CSBM MON FL IN S WALL C B 45FT W/O C/L BREA CYN RD & 0.35MI S/O C/L VIA SORELLA MKD (67-2A 1973)	CG 4209
OTTRBEIN (1980)	821.455	RAM SET 1FT N/O BCR @ NE COR PATHFINDER RD & WLY OFF RAMP ORANGE FWY 16FT E & 28FT N/O C/L INT	CG 4210
OTTRBEIN (1980)	821.160	CSBM MON FL IN WK ON PATHFINDER RD 20FT E/O W END BRIDGE OVER ORANGE FWY 28FT N & 117FT W/O C/L INT MKD (67-3A 1973)	CG 4211
OTTRBEIN (1980)	572.276	CSBM MON IN E WALL C B 42FT N/O C/L COLIMA RD & 127FT E/O C/L LEMON AVE MKD (BM 44-5A 1975)	CG 4222
OTTRBEIN (1980)	569.755	RDBM TAG 2FT E/O END CB (FUTURE BCR) @ NW COR COLIMA RD & LEMON AVE 42FT N & 50FT W/O C/L INT	CG 4223
OTTRBEIN (1980)	570.870	RDBM TAG IN NW COR CONC BASE SIGNAL CONTROL BOX 47FT E & 25FT S/O C/L INT COLIMA RD & BREA CYN CUT-OFF RD	CG 4224
OTTRBEIN (1980)	483.908	RDBM TAG IN W WALL C B 41FT E/O BCR @ SE COR WALNUT DR & FAIRWAY DR 24FT S & 125FT E/O C/L INT	CG 4225

JAD-YEAR	ELEV	DESCRIPTION (INCLUDE QUAD AND YEAR IN DESCRIPTION)	BM NUMBER
OTTRBEIN (1980)	691.843	RDBM TAG IN NE COR CONC SLAB OF GENERAL ELECTRIC HIGH VOLTAGE BOX 45FT N/O C/L GOLDEN SPRINGS DR & 0.5 MI W/O C/L GRAND AVE	CG 4231
OTTRBEIN (1980)	596.804	RDBM TAG IN CONC CB 34FT N/O C/L GOLDEN SPRINGS DR & 0.4 MI E/O C/L BREA CYN RD 50FT ELY C/L DR TO STATE OF CALIF DEPT OF TRANS YARD NO 21420	CG 4233
OTTRBEIN (1980)	596.974	RDBM TAG IN CONC CB 3FT W/O E END 34FT S/O C/L GOLDEN SPRINGS DR & 0.4 MI E/O BREA CYN RD 50FT E/O C/L DR TO STATE OF CALIF DEPT OF TRANS YARD NO 21420	CG 4234
OTTRBEIN (1980)	603.522	RDBM TAG IN NO CB BALAN RD 5FT W/O BCR 49FT W & 20FT N/O C/L INT PEPPERDALE DR	CG 4235
OTTRBEIN (1980)	607.111	RDBM TAG IN CONC CB 5FT W/O BCR 51FT W & 20FT N/O C/L INT ARCDALE AVE & BALAN RD	CG 4236
OTTRBEIN (1980)	564.908	RDBM TAG NR SW COR CONC DR TO HSE NO 2454 DESIRE AVE 288FT N & 22FT E/O INT PATHFINDER RD	CG 4237
OTTRBEIN (1980)	653.116	L&LS TAG NO 2427 NR C/L NATIVE AVE 3FT S/O END DR TO HSE NO 2804 50FT N/O C/L PATHFINDER RD	CG 4238
OTTRBEIN (1980)	648.015	RDBM TAG NR E END CONC WK TO HSE NO 2799 NATIVE AVE 125FT W/O C/L & 150FT N/O C/L PATHFINDER RD	CG 4239
OTTRBEIN (1980)	824.786	L&LS TAG 1FT S/O BCR @ SW COR DIAMOND BAR BLVD & ACACIA HILL RD 48FT S & 50FT W/O C/L INT MKD (LS 2602)	CG 4241
OTTRBEIN (1980)	845.916	RDBM TAG IN SLY WALL C B 51FT W/O C/L DIAMOND BAR BLVD & 790FT NLY INT MAPLE HILL RD FT OF HSE # 1729	CG 4242
OTTRBEIN (1980)	877.658	RDBM TAG 2FT S/O BCR @ SE COR DIAMOND BAR BLVD & QUAIL SUMMIT DR 47FT S & 50FT E/O C/L INT	CG 4243
OTTRBEIN (1980)	913.517	RCE TAG 11FT W/O BCR @ SW COR DIAMOND BAR BLVD & TIN DR 26FT S & 75FT W/O C/L INT MKD (RCE 14010)	CG 4244
OTTRBEIN (1980)	913.943	RCE TAG 11FT W/O BCR @ NW COR DIAMOND BAR BLVD & TIN DR 26FT N & 75FT W/O C/L INT MKD (RCE 14010)	CG 4245
BASELINE (1975)	330.120	RCE TAG NO 5828 IN CB 3FT N/O BCR @ NE COR MAIN ST & GLENDORA AVE 51FT N & 44FT E/O C/L INT	CG 4418

AD-YEAR	ELEV	DESCRIPTION (INCLUDE QUAD AND YEAR IN DESCRIPTION)	BM NUMBER
BASELINE (1975)	328.997	RDBM TAG IN CB 1FT N/O BCR @ NW COR STAFFORD ST & GLENDORA AVE 85FT N & 30FT W/O C/L INT	CG 4419
BASELINE (1975)	321.497	RDBM TAG IN E CB 1FT S/O BCR @ SE COR STAFFORD ST & HACIENDA BLVD 112FT S & 46FT E/O C/L INT	CG 4431
BASELINE (1975)	321.879	RDBM TAG IN S CB 1FT W/O BCR @ SW COR STAFFORD ST & HACIENDA BLVD 58FT W & 46FT S/O C/L INT	CG 4432
OTTRBEIN (1980)	486.211	L&T 1FT N/O BCR 20FT W/O C/L LARKVANE RD & 72FT N/O C/L COLIMA RD	CG 4520
OTTRBEIN (1980)	569.679	RDBM TAG IN WLY WALL C B 42FT S/O C/L COLIMA RD & 203FT E/O C/L BREA CYN CUT OFF RD (70FT E/O BCR)	CG 4521
OTTRBEIN (1980)	705.022	RDBM TAG 7FT W/O E END CONC HDWL 42FT S/O C/L GOLDEN SPRINGS DR & 0.45MI W/O C/L GRAND AVE	CG 4522
BASELINE (1975)	552.686	L&T IN C B 21FT N/O C/L EAST RD & 68FT E/O C/L HACIENDA BLVD	CG 4523
OTTRBEIN (1980)	603.752	RDBM TAG IN S CB BALAN RD 1FT W/O BCR 46FT W & 20FT S/O C/L INT PEPPERDALE DR	CG 4524
OTTRBEIN (1980)	641.610	RDBM TAG IN SE COR C B 64FT ELY C/L BREA CYN CUT OFF RD & 60FT SLY C/L ESQUILINE AVE	CG 4525
OTTRBEIN (1980)	484.315	RDBM TAG IN W WALL C B 24FT N/O C/L WALNUT DR & 105FT E/O C/L FAIRWAY DR	CG 4526
BASELINE (1975)	484.747	RCE TAG # 5828 42FT N/O C/L VALLEY BLVD & 75FT E/O C/L FAIRWAY DR	CG 4527
OTTRBEIN (1980)	781.931	L&B IN CB 69FT N/O & 50FT W/O C/L INT DIAMOND BAR BLVD & MORNING CYN RD	CG 4528
OTTRBEIN (1980)	779.965	L&RCE TAG #8793 IN CB 50FT W & 54FT S/O C/L INT DIAMOND BAR BLVD & MORNING CYN RD	CG 4529
OTTRBEIN (1980)	770.916	L&T @ NE COR PATHFINDER RD & DIAMOND BAR BLVD 50FT E/O & 57FT N/O C/L INT 3FT N/O BCR	CG 4530
OTTRBEIN (1980)	769.950	L&T IN CB 1FT S/O BCR 50FT E & 41FT S/O BAR BLVD & PATHFINDER RD	CG 4531
OTTRBEIN (1980)	738.748	RD TAG IN WK 1180FT S & 44FT E/O C/L INT COLD SPRINGS LANE & DIAMOND BAR BLVD	CG 4532
OTTRBEIN (1980)	428.156	L&RCE TAG # 5828 20FT N/O C/L RAILROAD ST ON C/L PROD FULLERTON RD	CG 4533

DAD-YEAR	ELEV	DESCRIPTION (INCLUDE QUAD AND YEAR IN DESCRIPTION)	BM NUMBER
OTTRBEIN (1980)	436.915	RDBM TAG IN CB 24FT W/O C/L JELLYCK AVE 150FT N/O END OF CUL DE SAC ON N SIDE OF POMONA FWY 0.10MI S/O MEHR AVE	CG 4534
OTTRBEIN (1980)	440.488	L&N IN W END CONC HDWL ON N SIDE POMONA FWY 27FT S/O END OF CUL DE SAC 8FT E/O C/L JELLYCK AVE 0.10MI S/O MEHR AVE	CG 4535
OTTRBEIN (1980)	440.554	RAMSET WITH CAL STATE DIV OF HWYS WASHER 20FT N/O C/L GREENBAY DR & 36FT E/O C/L JELLYCK AVE	CG 4536
OTTRBEIN (1980)	394.795	L&T CTR CB RET 46FT N/O C/L GALE AVE & 48FT W/O C/L AZUSA AVE	CG 4537
OTTRBEIN (1980)	790.929	DPW BM TAG N CB @ NW COR BUTTERFIELD RD (W SERV. RD CORONA EXPWY) & 9TH ST 18FT N & 72FT W/O C/L INT (21FT W/O BCR)	CG 4599
OTTRBEIN (1980)	790.878	DPW BM TAG S CB @ SW COR BUTTERFIELD RD (W SERV. RD CORONA EXPWY) & 9TH ST 18FT S & 74FT W/O C/L INT (23FT W/O BCR)	CG 4600
OTTRBEIN (1980)	819.630	DPW BM TAG N CB @ NW COR CORONA EXPWY & N RANCH RD 21FT N & 195FT W/O C/L INT (OPP END WALL & NEAR BC OF CB)	CG 4601
OTTRBEIN (1980)	819.619	DPW BM TAG S CB @ SW COR CORONA EXPWY & N RANCH RD 21FT S & 195FT W/O C/L INT (OPP END WALL & NEAR BC OF CB)	CG 4602
OTTRBEIN (1980)	793.031	DPW BM TAG N CB @ NW COR CORONA EXPWY & OLD POMONA RD 34FT N & 205FT W/O C/L INT (1FT W/O W END C B)	CG 4603
OTTRBEIN (1980)	793.216	DPW BM TAG S CB @ SW COR CORONA EXPWY & OLD POMONA RD 34FT S & 205FT W/O C/L INT (1FT W/O W END C B)	CG 4604
OTTRBEIN (1980)	884.734	DPW BM TAG N CB @ NE COR OLD POMONA RD & VILLAGE LOOP RD 66FT E & 34FT N/O C/L INT (3FT E/O BCR)	CG 4605
OTTRBEIN (1980)	885.405	DPW BM TAG S CB @ SE COR OLD POMONA RD & VILLAGE LOOP RD 62FT E & 34FT S/O C/L INT (3FT E/O BCR)	CG 4606
OTTRBEIN (1980)	858.755	DPW BM TAG E CB @ SE COR PHILLIPS RANCH RD & VILLAGE LOOP RD 60FT S & 35FT E/O C/L INT (2FT S/O BCR)	CG 4607
OTTRBEIN (1980)	858.584	DPW BM TAG W CB @ SW COR PHILLIPS RANCH RD & VILLAGE LOOP RD 75FT S & 35FT W/O C/L INT (2FT S/O BCR)	CG 4608

AD-YEAR	ELEV	DESCRIPTION (INCLUDE QUAD AND YEAR IN DESCRIPTION)	BM NUMBER
OTTRBEIN (1980)	895.766	RAMSET (NAIL) IN NE COR OF LIGHT BASE #28/041 28FT S & 28FT W/O THE MOST SLY ON-RAMP TO WEST BOUND POMONA FRWY & PILLIPS RANCH RD	CG 4609
OTTRBEIN (1980)	926.684	RAMSET (NAIL) IN SE COR CONC BRIDGE DECK @ PHILLIPS RANCH RD & POMONA FRWY OVERCROSSING (BR #53-2080 3FT N & 3FT E/O SE COR BRIDGE DECK)	CG 4610
OTTRBEIN (1980)	965.987	DPW BM TAG E CB @ NE COR PHILLIPS RANCH RD & SCENIC RIDGE DR 44FT N & 40FT E/O C/L INT (2FT N/O BCR)	CG 4611
OTTRBEIN (1980)	965.284	L&T W CB PHILLIPS RANCH RD 28FT N & 40FT W/O C/L INT SCENIC RIDGE DR & PHILLIPS RANCH RD	CG 4612
OTTRBEIN (1980)	911.582	DPW BM TAG IN E CB @ SE COR VILLAGE LOOP RD & OLD WOOD RD 54FT S & 28FT E/O C/L INT (2FT S/O BCR)	CG 4613
OTTRBEIN (1980)	912.486	DPW BM TAG IN E CB @ NE COR VILLAGE LOOP RD & OLD WOOD RD 48FT N & 28FT E/O C/L INT (2FT N/O BCR)	CG 4614
OTTRBEIN (1980)	933.973	DPW BM TAG N CB @ NE COR VILLAGE LOOP RD & SANTA CLARA RD 67FT E & 28FT N/O C/L INT (1FT E/O BCR)	CG 4615
OTTRBEIN (1980)	936.138	DPW BM TAG N CB @ NW COR VILLAGE LOOP RD & SANTA CLARA DR 54FT W & 28FT N/O C/L INT (1FT W/O BCR)	CG 4616
OTTRBEIN (1980)	1052.583	DPW BM TAG S CB @ SW COR SANTA CLARA DR & LOS FELIS DR 24FT S & 56FT W/O C/L INT (3FT W/O BCR)	CG 4617
OTTRBEIN (1980)	1053.224	DPW BM TAG N CB @ NW COR SANTA CLARA DR & LOS FELIS DR 24FT N & 52FT W/O C/L INT (1FT W/O BCR)	CG 4618
OTTRBEIN (1980)	961.465	DPW BM TAG S CB @ SE COR TEMPLE AVE & GOLDEN SPRINGS DR 24FT S & 69FT E/O C/L INT (3FT E/O BCR)	CG 4619
OTTRBEIN (1980)	956.941	DPW BM TAG S CB @ SW COR TEMPLE AVE & GOLDEN SPRINGS DR 36FT S & 68FT W/O C/L INT (1FT W/O BCR)	CG 4620
OTTRBEIN (1980)	896.767	DPW BM TAG S CB TEMPLE AVE @ SE COR 36FT S/O TEMPLE AVE & 90FT E/O DIAMOND BAR BLVD (2FT W/O BCR)	CG 4621
OTTRBEIN (1980)	891.056	DPW BM TAG W CB DIAMOND BAR BLVD @ SW COR 76FT S/O TEMPLE AVE & 42FT W/O DIAMOND BAR BLVD (1FT S/O BCR)	CG 4622

ROAD-YEAR	ELEV	DESCRIPTION (INCLUDE QUAD AND YEAR IN DESCRIPTION)	BM NUMBER
OTTRBEIN (1980)	982.769	DPW BM TAG W CB @ NW COR GRAND AVE & ROLLING KNOLL RD 48FT N & 40FT W/O C/L INT (1FT N/O BCR)	CG 4623
OTTRBEIN (1980)	990.410	RCE TAG #9757 W CB @ SW COR GRAND AVE & ROLLING KNOLL RD 50FT S & 40FT W/O C/L INT (1FT S/O BCR)	CG 4624
OTTRBEIN (1980)	1159.720	DPW BM TAG W CB @ NW COR GRAND AVE & SHOTGUN LN 48FT N & 42FT W/O C/L INT (1FT N/O BCR)	CG 4625
OTTRBEIN (1980)	1160.352	DPW BM TAG W CB @ SW COR GRAND AVE & SHOTGUN LN 48FT S & 42FT W/O C/L INT (1FT S/O BCR)	CG 4626
OTTRBEIN (1980)	1035.046	DPW BM TAG W CB @ NW COR GRAND AVE & LONGVIEW DR 52FT N & 44FT W/O C/L INT (1FT N/O BCR)	CG 4627
OTTRBEIN (1980)	1028.734	DPW BM TAG S CB @ SE COR LONGVIEW DR & GRAND AVE 25FT S & 75FT E/O C/L INT (9FT E/O BCR)	CG 4628
OTTRBEIN (1980)	1037.993	L&BRAD IN CB @ NW COR LONGVIEW DR & STARDUST DR 20FT N & 41FT W/O C/L INT (1FT W/O BCR)	CG 4629
OTTRBEIN (1980)	1039.096	L&BRAD IN CB @ NW COR LONGVIEW DR & STARDUST DR 20FT N & 41FT E/O C/L INT (NR WEST END C B)	CG 4630